

AGENDA
HARMONY CITY COUNCIL
Regular Meeting

November 14, 2017
7:00 P.M.

Council Room
Community Center

1. Call To Order
2. Roll Call
3. Public Forum
4. Public Hearing-2017 Street and Utility Project Assessments
5. Consent Agenda
 - a. Minutes
 - b. Claims
 - c. Administrator Report
 - d. Financial Report
 - e. CD
 - f. Fire Relief Association
 - g. County Hazard Mitigation Plan
 - h. Non-Union Health Insurance Renewal
 - i. ISO Rating Report
6. Reports
 - a. 2017 Street and Utility Project
 - b. Fire Department and Fire Relief Association
 - c. Building & Maintenance Report
 - d. EDA Board
 - e. Park Board
 - f. Library Board
 - g. Arts Board
7. Adjourn

**BACKGROUND INFORMATION
HARMONY CITY COUNCIL
REGULAR MEETING**

**November 14, 2017
7:00 P.M.**

**Council Room
Community Center**

1. Call To Order
2. Roll Call
3. Public Forum
4. Public Hearing-2017 Street and Utility Project Assessments
5. Consent Agenda
 - a. Minutes
 - b. Claims
 - c. Administrator Report-See report.
 - d. Financial Report-See report.
 - e. CD-Cash in CD #43699.
 - f. Fire Relief Association-Approve internal bank transfer for Fire State Aid of \$16,203.17 and annual city contribution of \$7,500 once state fire aid is received from State of MN.
 - g. County Hazard Mitigation Plan-See enclosed information. Consider resolution 17-07.
 - h. Non-Union Health Insurance Renewal-Approve renewal based upon personnel committee's recommendation.
 - i. ISO Rating Report-See enclosed report.
6. Reports
 - a. 2017 Street and Utility Project-Update on project. See assessment hearing handout. Consider proposed assessment roll as presented. Consider resolution 17-08 for final assessment role.
 - b. Fire Department and Fire Relief Association-Fire Chief Rod Johnson will be present to discuss service pension change. Consider approval of fire pension change increase from \$850/year of service to \$900/year of service.
 - c. Building & Maintenance Report
 - d. EDA Board
 - e. Park Board
 - f. Library Board
 - g. Arts Board
7. Adjourn

OCTOBER 10, 2017

REGULAR MEETING

HARMONY CITY COUNCIL

A Regular meeting of the Harmony City Council was called to order by Mayor Steve Donney at 7:00 PM. Present were Mayor Donney, Councilmembers Kyle Morem, Steve Sagen, and Lynn Mensink; Attorney Greg Schieber, Administrator Jerome Illg, Chris Johnson, Julie Lau, Melissa VanderPlas, Hannah Wingert, and Eileen Schansberg. Absent was Councilmember Debbie Swenson.

PUBLIC FORUM:

Julie Lau expressed concerns about enforcement of ordinances. Mayor Donney explained that Law Enforcement was responsible for violations. Lau expressed concern regarding the service the deputies were giving the community. Lau stated the Deputies need to be held accountable for their actions. No action was taken.

CONSENT AGENDA:

Motion by Mensink and seconded by Morem to approve the Consent Agenda which consisted of the minutes to the September 12, 2017 meeting, the claims, the Administrators Report, Financial Report, cashing CD #43698 in to the General Fund, Approval of the MMUA Mutual Aid Agreement and the establishment of Ordinance No. 53.75: AN ORDINANCE REGULATING NONESSENTIAL WATER USAGE UPON CRITICAL WATER DEFICIENCY AS AUTHORIZED BY MINN.STAT. § 103g.291, SUBD. 1 AND 2.

Voting for was: Morem, Sagen, Mensink and Donney.

Voting against was: No One

Abstained from voting was: No One

Absent was Swenson.

The motion passed and Consent Agenda along with Ordinance No. 53.75 was approved.

2017 UTILITY IMPROVEMENTS:

-An update was given on the 2017 Utility Project. Motion by Morem and seconded by Mensink to call for a final Assessment Hearing on November 14, 2017 at 7:00 PM. All present voting yes. Absent was Swenson. Motion carried. Notices will be sent to residents in the next few weeks.

BUILDING & MAINTENANCE:

-Will be hauling sludge this fall.

-Will be getting a price from Hammell Equipment about renting a tractor just to stir sludge instead of tying up our tractor.

EDA REPORT:

-Attorney Greg Schieber discussed the trip to the Capital to lobby the LCCMR for funding for the bike trail to Niagara Cave and the Iowa Border. It was noted it may be spring before we know if it would be funded.

-It was mentioned that Harmony Spirits is finalizing their financing which caused a slight delay in the project.

-Final decision was made on the city LOGO giving everyone using it, the right to choose the color they prefer.

PARK BOARD:

-Putting the Gazebo roof in Selvig Park off until spring.

-A list of park repairs has been completed.

- Approved ordering a new mower from Run Right Power and trading in an older one.
- Two estimates were reviewed for a new ATV. Motion by Morem and seconded by Mensink to purchase the UTV from Hammel Equipment in the amount of \$12,959.00 with half being paid by the Park Fund and half from the City General Fund (similar to what has been done in the past). All present voting yes. Absent was Swenson. Motion carried.

LIBRARY BOARD:

- Waiting on the delivery of the Clothing Bin. The contents will be picked up once a week.
- Working on activities for winter and spring.
- A \$1,000 anonymous donation was given for the patio restoration project.

ARTS BOARD:

- Children's Theatre was put off until spring.
- A \$400 donation was donated to help 6th thru 8th graders attend the Young Writers Academy. Question was asked if the Preston Arts Board was also participating. Council felt Preston should be asked to match Harmony's contribution.

WWTP:

Two estimates were received for a gate to lock up the Wastewater Plant. The consensus of the council was to use the lesser estimate and proceed with the purchase in the amount of \$3,200 from Horsman Fence Co. The gate would be wider to allow for better access for sludge hauling and snow plowing.

Upon no further business, Mayor Donney adjourned the meeting.

Mayor Steve Donney

Eileen Schansberg, Deputy Clerk

CITY OF HARMONY

City Council Claims for Review

11/09/17 5:15 PM

Page 1

November 14, 2017

Fund Descr	Department	Object of Expense	Vendor	Comments	Amount
Fund 101 General Fund					
General Fund		Union Central Pension Fund	CENTRAL PENSION FUND	union pension Chris, Brian, Corey	\$264.00
General Fund		Health Insurance	I.U.O.E. LOCAL 49 FRINGE BENEF	Union health insurance	\$3,510.00
General Fund		Union Dues	IUOE LOCAL #49	Union dues	\$103.50
General Fund		NCPERS Insurance	NCPERS GROUP LIFE INS	511800	\$48.00
General Fund		Life Insurance	USABLE LIFE	101421301G	\$75.10
General Fund	Administration	Motor Fuels/Lubricants	KWIK TRIP, INC	gas-Van	\$24.90
General Fund	Civil Defense	Telephone	HARMONY TELEPHONE COMPANY	Sirens/DSL Phone	\$89.42
General Fund	Community Center	Building Repair Materials	MOREM ELECTRIC, INC	exit light bulbs	\$72.18
General Fund	Community Center	Building Repair Materials	MOREM ELECTRIC, INC	exit light batteries	\$266.16
General Fund	Community Center	Building Repair Materials	MOREM ELECTRIC, INC	Comm Ctr outside light	\$383.63
General Fund	Community Center	Cleaning Supplies	DALCO	gloves/paper goods/cleaning supply	\$166.37
General Fund	Community Center	Cleaning Supplies	DALCO	bath tissue	\$13.95
General Fund	Community Center	Cleaning Supplies	DALCO	bath tissue	\$24.72
General Fund	Community Center	Electric Utilities	HARMONY PUBLIC UTILITIES	Elec-Comm Ctr	\$672.31
General Fund	Community Center	Gas Utilities	MINNESOTA ENERGY	monthly gas bill-Comm Ctr	\$167.71
General Fund	Community Center	General Operating Supplies	KINGSLEY MERCANTILE	paint supplies/plug/bolts/joint compound	\$50.73
General Fund	Community Center	General Operating Supplies	S & S AUTOMOTIVE	adapter/tire chuck	\$13.68
General Fund	Community Center	Motor Fuels/Lubricants	KWIK TRIP, INC	gas-Terry pickup	\$51.02
General Fund	Community Center	Repair/Maint Vehicles	BLAINES AUTO	routine maintenance-Terrys pickup	\$34.80
General Fund	Community Center	Sewer Utilities	HARMONY PUBLIC UTILITIES	sewer-Comm Ctr	\$55.80
General Fund	Community Center	Small Tools and Minor Equip	KINGSLEY MERCANTILE	screwdriver	\$5.98
General Fund	Community Center	Telephone	HARMONY TELEPHONE COMPANY	Admin Phone/DSL	\$230.91
General Fund	Community Center	Water Utilities	HARMONY PUBLIC UTILITIES	water-Comm Ctr	\$35.03
General Fund	Community Development	Legal Notices Publishing	BLUFF COUNTRY NEWSPAPER GROUP	'17 Sp Assessment notices	\$44.00
General Fund	Ice & Snow Removal	Equipment Parts	H & L MESABI	plow blades	\$837.60
General Fund	Ice & Snow Removal	Equipment Parts	S & S AUTOMOTIVE	oil filters/fuel filters	\$167.98
General Fund	Ice & Snow Removal	Equipment Parts	S & S AUTOMOTIVE	air filters	\$87.98
General Fund	Ice & Snow Removal	Motor Fuels/Lubricants	S & S AUTOMOTIVE	oil	\$148.96
General Fund	Ice & Snow Removal	Repair/Maint Vehicles	HAMMELL EQUIPMENT	skid loader light part	\$15.50
General Fund	Legal Services	Legal Fees	NETHERCUT SCHIEBER ATTORNEYS	legal services for Oct	\$174.00
General Fund	Personnel Administration	General Operating Supplies	CULLIGAN	Wellness Program	\$52.90
General Fund	Personnel Administration	General Operating Supplies	SCHANSBERG, EILEEN	wellness	\$15.96
General Fund	Personnel Administration	Uniforms	HI-VIZ SAFETY	high visible clothing-Brian	\$195.50
General Fund	Personnel Administration	Uniforms	HI-VIZ SAFETY	high visible clothing-Corey	\$187.50
General Fund	Personnel Administration	Uniforms	HI-VIZ SAFETY	high visible clothing-Terry	\$116.00
General Fund	Police Department	Motor Fuels/Lubricants	SEVERSON OIL CO.	gas-Squad	\$420.20

CITY OF HARMONY

City Council Claims for Review

11/09/17 5:15 PM

Page 2

November 14, 2017

Fund Descr	Department	Object of Expense	Vendor	Comments	Amount
General Fund	Police Department	Telephone	HARMONY TELEPHONE COMPANY	Police Phone	\$44.68
General Fund	Public Works Buildings	Cleaning Supplies	IRONSIDE TRAILER SALES & SERVI	disposal of 3 tires	\$12.00
General Fund	Public Works Buildings	Cleaning Supplies	S & S AUTOMOTIVE	green cleaner	\$83.99
General Fund	Public Works Buildings	Electric Utilities	HARMONY PUBLIC UTILITIES	Elec-Shop	\$126.99
General Fund	Public Works Buildings	Gas Utilities	MINNESOTA ENERGY	monthly gas bill-Shop	\$61.99
General Fund	Public Works Buildings	General Operating Supplies	MISSISSIPPI WELDERS SUPPLY CO	oxygen cylinders annual	\$96.00
General Fund	Public Works Buildings	General Operating Supplies	MISSISSIPPI WELDERS SUPPLY CO	oxygen cylinder	\$32.86
General Fund	Public Works Buildings	Motor Fuels/Lubricants	SEVERSON OIL CO.	diesel-generator	\$11.68
General Fund	Public Works Buildings	Small Tools and Minor Equip	S & S AUTOMOTIVE	oil filter strap/wrench/wire	\$85.43
General Fund	Public Works Buildings	Water Utilities	HARMONY PUBLIC UTILITIES	water-Shop	\$21.93
General Fund	Streets	Equipment Parts	S & S AUTOMOTIVE	gauge, Aire Filters, signal lamp	\$87.15
General Fund	Streets	General Operating Supplies	KINGSLEY MERCANTILE	softner salt/glue/primer	\$29.06
General Fund	Streets	Motor Fuels/Lubricants	KWIK TRIP,INC	gas-1 ton	\$68.23
General Fund	Streets	Motor Fuels/Lubricants	S & S AUTOMOTIVE	diesel exhaust	\$29.98
General Fund	Streets	Motor Fuels/Lubricants	SEVERSON OIL CO.	gas-1 ton	\$68.42
General Fund	Streets	Repair/Maint Other Improve	LEGENDS CONCRETE, INC	repair curb runoff 4th/2nd Ave NW	\$1,009.91
General Fund	Streets	Small Tools and Minor Equip	KINGSLEY MERCANTILE	blades	\$21.49
General Fund	Streets	Street Maint Materials	BRUENING ROCK PRODUCTS, INC	road rock	\$234.09
General Fund	Streets	Street Maint Materials	BRUENING ROCK PRODUCTS, INC	road rock	\$225.45
General Fund	Streets	Street Maint Materials	S & S AUTOMOTIVE	white paint	\$77.88
General Fund	Streets	Tires	BAUER BUILT	new tires for '15 Ford pickup-Chris pickup	\$537.64
General Fund	Streets	Tires	ELAN FINANCIAL SERVICES	Coil for UTV	\$43.10
General Fund	Visitor Center	Cleaning Supplies	DALCO	bathroom supplies	\$38.66
General Fund	Visitor Center	Cleaning Supplies	DALCO	bath tissue	\$24.72
General Fund	Visitor Center	Gas Utilities	MINNESOTA ENERGY	monthly gas bill-Vis Ctr	\$72.20
General Fund	Visitor Center	Motor Fuels/Lubricants	KWIK TRIP,INC	gas-Terry pickup	\$51.01
General Fund	Visitor Center	Repair/Maint Vehicles	BLAINES AUTO	routine maintenance-Terrys pickup	\$34.81
General Fund	Visitor Center	Sewer Utilities	HARMONY PUBLIC UTILITIES	sewer-Vis Ctr	\$62.84
General Fund	Visitor Center	Water Utilities	HARMONY PUBLIC UTILITIES	water-Vis Ctr	\$39.43
General Fund	Visitor Center	Water Utilities	HARMONY PUBLIC UTILITIES	Elec-Vis Ctr	\$132.08
Fund 101 General Fund					\$12,289.68
Fund 202 CDBG Rehab Loan Program					
CDBG Rehab Loan Progr	Loan Programs	Loans Made	MINNESOTA BUILDING CONTRACTOR	Res Rehab HH-003 pmt #2	\$18,248.00
CDBG Rehab Loan Progr	Loan Programs	Loans Made	NORSE VALLEY CONSTRUCTION, LLC	Res Reb HH-009 Pmt #1	\$22,275.00
CDBG Rehab Loan Progr	Loan Programs	Management Fees	CEDA	retainer services for SCDP Grant	\$386.75
Fund 202 CDBG Rehab Loan Program					\$40,909.75

CITY OF HARMONY

City Council Claims for Review

11/09/17 5:15 PM

Page 3

November 14, 2017

Fund Descr	Department	Object of Expense	Vendor	Comments	Amount
Fund 211 Library Fund					
Library Fund	Library	General Operating Supplies	HARMONY FOODS	Halloween Candy	\$26.92
Library Fund	Library	Media-Audio	INGRAM LIBRARY SERVICES, INC	Audio books	\$32.99
Library Fund	Library	Media-Books	BAKER & TAYLOR	book	\$15.36
Library Fund	Library	Media-Books	BAKER & TAYLOR	books	\$129.83
Library Fund	Library	Media-Books	CENTER POINT LARGE PRINT	large print books	\$44.34
Library Fund	Library	Media-Books	FREDERICK, MICHAEL	book	\$25.00
Library Fund	Library	Media-Books	GALE GROUP	books	\$62.38
Library Fund	Library	Media-Video	AMAZON CAPITAL SERVICES	dvds	\$39.95
Library Fund	Library	Media-Video	AMAZON CAPITAL SERVICES	dvds	\$139.96
Library Fund	Library	Media-Video	AMAZON CAPITAL SERVICES	dvds	\$83.77
Library Fund	Library	Media-Video	AMAZON CAPITAL SERVICES	dvds	\$38.97
Library Fund	Library	Media-Video	AMAZON CAPITAL SERVICES	dvds	\$17.96
Library Fund	Library	Media-Video	AMAZON CAPITAL SERVICES	dvds	\$19.96
Library Fund	Library	Media-Video	AMAZON CAPITAL SERVICES	dvds	\$53.07
Library Fund	Library	Media-Video	AMAZON CAPITAL SERVICES	dvds	\$66.90
Library Fund	Library	Media-Video	AMAZON CAPITAL SERVICES	dvds	\$52.01
Library Fund	Library	Motor Fuels/Lubricants	KWIK TRIP, INC	van gas	\$17.01
Library Fund	Library	Postage	SOUTHEASTERN LIBRARIES COOP	postage on mailers	\$47.38
Library Fund	Library	Printed Forms	SOUTHEASTERN LIBRARIES COOP	mailers & SMS notices	\$36.90
Library Fund	Library	Software Service Fees	SOUTHEASTERN LIBRARIES COOP	Basic services & PC Support	\$577.36
Library Fund	Library	Telephone	HARMONY TELEPHONE COMPANY	Library Phone	\$47.93
Fund 211 Library Fund					\$1,575.95
Fund 222 Fire Fund					
Fire Fund	Fire Department	Equipment Parts	ANCOM TECHNICAL CENTER	battery paks; Li Ion Batteries; holster belt	\$720.00
Fire Fund	Fire Department	Equipment Parts	ANCOM TECHNICAL CENTER	4 radio batteries	\$523.00
Fire Fund	Fire Department	Motor Fuels/Lubricants	KWIK TRIP, INC	diesel-Generator	\$24.93
Fire Fund	Fire Department	Other Equipment	COM-TEC LAND MOBILE RADIO	Lightbar mounted on truck	\$1,880.00
Fire Fund	Fire Department	Repair/Maint Machinery/Equip	MACQUEEN EMERGENCY GROUP	Fire pumper repairs (Harmony 1/3 portion	\$2,802.86
Fire Fund	Fire Stations and Bldgs	Electric Utilities	HARMONY PUBLIC UTILITIES	Elec-Firehall	\$267.96
Fire Fund	Fire Stations and Bldgs	Gas Utilities	MINNESOTA ENERGY	monthly gas bill-Firehall	\$48.32
Fire Fund	Fire Stations and Bldgs	Sewer Utilities	HARMONY PUBLIC UTILITIES	sewer-Firehall	\$25.40
Fire Fund	Fire Stations and Bldgs	Telephone	HARMONY TELEPHONE COMPANY	Fire Phone	\$44.68
Fire Fund	Fire Stations and Bldgs	Water Utilities	HARMONY PUBLIC UTILITIES	water-Firehall	\$16.03
Fund 222 Fire Fund					\$6,353.18
Fund 223 Ambulance Fund					

CITY OF HARMONY

City Council Claims for Review

11/09/17 5:15 PM

Page 4

November 14, 2017

Fund Descr	Department	Object of Expense	Vendor	Comments	Amount
Ambulance Fund	Ambulance Service	Financial Services Fees	EXPERT T BILLING	Amb missed billing-May	\$405.00
Ambulance Fund	Ambulance Service	Financial Services Fees	EXPERT T BILLING	Amb billing-Sept	\$405.00
Ambulance Fund	Ambulance Service	General Operating Supplies	DALCO	gloves returned	-\$72.08
Ambulance Fund	Ambulance Service	Medical and Dental Fees	GOLD CROSS AMBULANCE	Intercept chgs MM	\$201.89
Ambulance Fund	Ambulance Service	Medical and Dental Fees	GOLD CROSS AMBULANCE	Intercept chgs SM	\$189.59
Ambulance Fund	Ambulance Service	Medical and Dental Fees	TRI STATE AMBULANCE SERVICE	Intercept chgs IR	\$250.00
Ambulance Fund	Ambulance Service	Medical and Dental Fees	TRI STATE AMBULANCE SERVICE	Intercept chgs NW	\$250.00
Ambulance Fund	Ambulance Service	Medical Supplies	DALCO	exam gloves	\$72.08
Ambulance Fund	Ambulance Service	Medical Supplies	EMERGENCY MEDICAL PRODUCTS	Ambulance supplies	\$288.54
Ambulance Fund	Ambulance Service	Medical Supplies	MISSISSIPPI WELDERS SUPPLY CO	Oxygen	\$80.88
Ambulance Fund	Ambulance Service	Medical Supplies	MISSISSIPPI WELDERS SUPPLY CO	Oxygen	\$34.01
Ambulance Fund	Ambulance Service	Motor Fuels/Lubricants	KWIK TRIP,INC	diesel-Ambulance	\$244.30
Ambulance Fund	Ambulance Service	Other Improvements	BRUENING ROCK PRODUCTS, INC	rock on drive for helipad	\$824.33
Ambulance Fund	Ambulance Service	Other Improvements	TLC EXCAVATING	finish grading & seeding Helipad landscapi	\$840.00
Ambulance Fund	Ambulance Service	Postage	ELAN FINANCIAL SERVICES	mailing Medicare Revalidation	\$7.25
Ambulance Fund	Ambulance Service	Telephone	ELAN FINANCIAL SERVICES	Amb cell service-Verizon	\$47.73
Ambulance Fund	Ambulance Service	Telephone	VERIZON WIRELESS	monthly cell service	\$47.59
Ambulance Fund	Ambulance Service	Training Fees	ELAN FINANCIAL SERVICES	Conference registration Tieffenbacher	\$35.00
Ambulance Fund	Ambulance Service	Training Fees	ELAN FINANCIAL SERVICES	Conference registration A Johnson	\$35.00
Ambulance Fund	Ambulance Service	Training Fees	ELAN FINANCIAL SERVICES	Conference registration Bigalk	\$35.00
Fund 223 Ambulance Fund					\$4,221.11
Fund 251 Park Fund					
Park Fund	Parks	Electric Utilities	HARMONY PUBLIC UTILITIES	Elec-parks	\$206.98
Park Fund	Parks	General Operating Supplies	KINGSLEY MERCANTILE	RV Antifreeze/grinder wheels/adapter	\$45.16
Park Fund	Parks	Motor Fuels/Lubricants	KWIK TRIP,INC	gas-UTV	\$62.08
Park Fund	Parks	Motor Fuels/Lubricants	RUN RIGHT POWER LLC	gallon 4 stroke fuel	\$27.95
Park Fund	Parks	Other Rentals	ON SITE SANITATION	toilet rental	\$36.00
Park Fund	Parks	Repair/Maint Other Improve	LAWN PRO	pre paid lawn treatment	\$146.55
Park Fund	Parks	Repair/Maint Other Improve	RUN RIGHT POWER LLC	sharpen chain	\$7.00
Park Fund	Parks	Sewer Utilities	HARMONY PUBLIC UTILITIES	sewer-parks	\$118.00
Park Fund	Parks	Sign Materials	KELLY PRINTING & SIGNS	UTV lettering	\$20.00
Park Fund	Parks	Small Tools and Minor Equip	RUN RIGHT POWER LLC	blower gutter kit	\$37.19
Park Fund	Parks	Water Utilities	HARMONY PUBLIC UTILITIES	water-parks	\$148.12
Park Fund	Recreation	Donations to Civic Org s	FILLMORE CENTRAL DIST. OFFICE	donation to 2017 Summer Rec program	\$7,565.12
Fund 251 Park Fund					\$8,420.15
Fund 601 Water Fund					

CITY OF HARMONY

City Council Claims for Review

11/09/17 5:15 PM

Page 5

November 14, 2017

Fund Descr	Department	Object of Expense	Vendor	Comments	Amount
Water Fund	Water Utility Operation	Chemicals and Chem Products	HAWKINS WATER TREATMENT GROU	chlorine cylinders demmorage	\$20.00
Water Fund	Water Utility Operation	Chemicals and Chem Products	HAWKINS WATER TREATMENT GROU	flouride	\$475.48
Water Fund	Water Utility Operation	Contractual Services	MCCARTHY WELL COMPANY	Well inspection	\$245.00
Water Fund	Water Utility Operation	Electric Utilities	HARMONY PUBLIC UTILITIES	Elec-pumphouses	\$1,888.69
Water Fund	Water Utility Operation	Gas Utilities	MINNESOTA ENERGY	monthly gas bill-pumphouses	\$42.43
Water Fund	Water Utility Operation	Laboratory & Testing Fees	UTILITY CONSULTANTS, INC	Water Testing Lab Fees	\$60.00
Water Fund	Water Utility Operation	Repair/Maint Other Improve	MAGUIRE IRON, INC.	Exterior painting water tower	\$41,905.00
Water Fund	Water Utility Operation	Utility Maint Materials	METERING & TECHNOLOGY SOLUTIO	water meters	\$1,204.91
Fund 601 Water Fund					\$45,841.51
Fund 602 Sewer Fund					
Sewer Fund	Sewer Administration	Postage	HARMONY ENTERPRISES COMPANY	return part by UPS	\$14.93
Sewer Fund	Sewer Operation	Chemicals and Chem Products	HAWKINS WATER TREATMENT GROU	chlorine cylinder demmurrage	\$5.00
Sewer Fund	Sewer Operation	Electric Utilities	HARMONY PUBLIC UTILITIES	Elec-WWTP	\$1,442.75
Sewer Fund	Sewer Operation	Equipment Parts	KINGSLEY MERCANTILE	batteries	\$16.97
Sewer Fund	Sewer Operation	Gas Utilities	MINNESOTA ENERGY	monthly gas bill-WWTP	\$107.43
Sewer Fund	Sewer Operation	Laboratory & Testing Fees	UTILITY CONSULTANTS, INC	Wastewater Testing Lab Fees	\$1,635.40
Sewer Fund	Sewer Operation	Motor Fuels/Lubricants	KWIK TRIP, INC	gas-1 ton	\$68.22
Sewer Fund	Sewer Operation	Motor Fuels/Lubricants	S&A PETROLEUM, INC	oil	\$545.58
Sewer Fund	Sewer Operation	Motor Fuels/Lubricants	S&A PETROLEUM, INC	diesel for generator	\$101.53
Sewer Fund	Sewer Operation	Motor Fuels/Lubricants	SEVERSON OIL CO.	gas-1 ton	\$66.11
Sewer Fund	Sewer Operation	Repair/Maint Other Equipment	HORSMAN FENCE	gate for WW Plant	\$3,200.00
Sewer Fund	Sewer Operation	Sewer Utilities	HARMONY PUBLIC UTILITIES	sewer-WWTP	\$1,740.28
Sewer Fund	Sewer Operation	Telephone	HARMONY TELEPHONE COMPANY	Lift Stations Dialer/DSL Phone	\$144.46
Sewer Fund	Sewer Operation	Utility Maint Materials	TEAM LABORATORY CHEM. CORP.	bugs	\$633.50
Sewer Fund	Sewer Operation	Utility Maint Materials	TEAM LABORATORY CHEM. CORP.	root killer	\$1,833.50
Sewer Fund	Sewer Operation	Utility Maint Materials	USA BLUEBOOK	buffer dyes/electrode storage solution/pH	\$100.21
Sewer Fund	Sewer Operation	Water Utilities	HARMONY PUBLIC UTILITIES	water-WWTP	\$1,087.83
Fund 602 Sewer Fund					\$12,743.70
Fund 603 Solid Waste Fund					
Solid Waste Fund	Solid Waste Operation	Refuse/Garbage Disposal	FILLMORE CO. RESOURCE RECOVERY	disposal-cleaning up	\$421.50
Solid Waste Fund	Solid Waste Operation	Repair/Maint Other Improve	SOLBERG WELDING	parts for leaf vac box mount	\$193.37
Fund 603 Solid Waste Fund					\$614.87
Fund 604 Electric Fund					
Electric Fund		Utility Deposits	HARMONY PUBLIC UTILITIES	Deposit to Utilities Garbisch	\$150.00
Electric Fund	Electric Utility Operation	Electric Power for Resale	MI ENERGY COOPERATIVE	Power for Resale	\$59,466.28

CITY OF HARMONY

City Council Claims for Review

11/09/17 5:15 PM

Page 6

November 14, 2017

Fund Descr	Department	Object of Expense	Vendor	Comments	Amount
Electric Fund	Electric Utility Operation	Electric Utilities	HARMONY PUBLIC UTILITIES	Elec-town clock	\$13.03
Electric Fund	Electric Utility Operation	Electric Utilities	HARMONY PUBLIC UTILITIES	Elec-streetlights	\$1,567.85
Electric Fund	Electric Utility Operation	Motor Fuels/Lubricants	KWIK TRIP, INC	gas-Chris pickup	\$71.66
Electric Fund	Electric Utility Operation	Motor Fuels/Lubricants	SEVERSON OIL CO.	gas-Chris pickup	\$70.27
Electric Fund	Electric Utility Operation	Repair/Maint Other Improve	GOPHER STATE ONE CALL, INC	locates/no locates	\$22.95
Electric Fund	Electric Utility Operation	Repair/Maint Other Improve	MOREM ELECTRIC, INC	streetlight Village Depot LED retrofit/3rd A	\$503.51
Electric Fund	Electric Utility Operation	Repair/Maint Other Improve	MOREM ELECTRIC, INC	repair streetlight Selvig Park; 4th St NE	\$449.01
Electric Fund	Electric Utility Operation	Repair/Maint Other Improve	MOREM ELECTRIC, INC	LED retrofit lights 4th/139; 139/1st St NW	\$454.00
Electric Fund	Electric Utility Operation	Repair/Maint Other Improve	MOREM ELECTRIC, INC	repair conduit by Cetera Office	\$147.23
Electric Fund	Electric Utility Operation	Repair/Maint Other Improve	MOREM ELECTRIC, INC	underground to 320 Ctr St E	\$698.72
Electric Fund	Electric Utility Operation	Repair/Maint Other Improve	MOREM ELECTRIC, INC	fix streetlights Niagara broken wire; replac	\$1,663.87
Electric Fund	Electric Utility Operation	Repair/Maint Vehicles	IRONSIDE TRAILER SALES & SERVI	strobe light-Chris pickup	\$346.50
Electric Fund	Electric Utility Operation	Utility Maint Materials	USA BLUEBOOK	DO Meter	\$1,005.84
Electric Fund	Electric UtilityAdministratio	Miscellaneous	ENERGY REBATE	Energy rebate-Bruflodt	\$75.00
Fund 604 Electric Fund					\$66,705.72
Fund 620 Economic Development Authority					
Economic Development	Economic Development	Planning & Development Fees	CEDA	4th Qtr Economic Development Contract	\$7,138.50
Economic Development	Economic Development	Program Services	ELAN FINANCIAL SERVICES	SurveyMonkey set-up	\$35.00
Economic Development	Economic Development	Sign Materials	KELLY PRINTING & SIGNS	Harmony EDA Trail signs	\$667.87
Economic Development	Economic Development	Telephone	HARMONY TELEPHONE COMPANY	EDA Phone	\$18.56
Fund 620 Economic Development Authority					\$7,859.93
					\$207,535.55

ADMINISTRATOR'S REPORT

For the Period from October 10, 2017 to November 14, 2017

ADMINISTRATION

Finalized and mailed out assessment notices for 2017 street project.

MNDOT has approved permit for Historical Society to install 6 signs in right-of-way. They will be installed in Spring 2018.

Handled ISO rating. Have enclosed for reference full report for explanation of rating.

Assembling information for Well #3 DNR appropriation permit. Have begun process of updating Wellhead Protection Plan for this well. Water supply plan was submitted.

Contracts have been signed for Hammel House development project. Utilities are installed. All grading with rock is complete on street. Curb, gutter, and paving will be completed spring 2018.

Administered solid waste tax audit. We may have to handle an audit adjustment for our dumpsters that are part of Waste Management contract.

UTILITY/BUILDING COMMITTEE

The contractor has water, sewer, curb and gutter installed in all of the areas for our 2017 Street and Utility Project. It has been paved with first lift of asphalt. Final lift will be installed in 2018.

Installation of water main loop by firehall, wastewater plant, to Walnut Farms is complete.

MNDOT has finished up mill and overlay on TH139 from Hwy 52 to State Line in 2017.

PERSONNEL COMMITTEE

Counterproposal to union contract has been sent to union.

Reviewed non-union health insurance.

Resolution 17-07

RESOLUTION FOR THE ADOPTION OF THE FILLMORE COUNTY ALL-HAZARD
MITIGATION PLAN

WHEREAS, the City of Harmony has participated in the hazard mitigation planning process as established under the Disaster Mitigation Act of 2000, and

WHEREAS, the Act establishes a framework for the development of a multi-jurisdictional County Hazard Mitigation Plan; and

WHEREAS, the Act as part of the planning process requires public involvement and local coordination among neighboring local units of government and businesses; and

WHEREAS, the Fillmore County Plan includes a risk assessment including past hazards, hazards that threaten the County, an estimate of structures at risk, a general description of land uses and development trends; and

WHEREAS, the Fillmore County Plan includes a mitigation strategy including goals and objectives and an action plan identifying specific mitigation projects and costs; and

WHEREAS, the Fillmore County Plan includes a maintenance or implementation process including plan updates, integration of the plan into other planning documents and how Fillmore County will maintain public participation and coordination; and

WHEREAS, the Fillmore County Plan has been shared with the Minnesota Division of Homeland Security and Emergency Management and the Federal Emergency Management Agency for review and comment; and

WHEREAS, the Fillmore County All-Hazard Mitigation Plan will make the county and participating jurisdictions eligible to receive FEMA hazard mitigation assistance grants; and

WHEREAS, this is a multi-jurisdictional Plan and cities that participated in the planning process may choose to also adopt the Fillmore County Plan.

NOW THEREFORE BE IT RESOLVED that the City of Harmony supports the hazard mitigation planning effort and wishes to adopt the Fillmore County All-Hazard Mitigation Plan.

The foregoing resolution was introduced and moved for adoption by Council Member _____ and seconded by Council Member _____.

Voting for the Resolution:

Voting Against the Resolution:

Abstained from Voting:

Absent:

Motion carried and resolution adopted this 14th day of November 2017.

Steve Donney, Mayor

ATTEST:

Jerome Illg, Administrator

City of Harmony

From: Beck, Kevin <kbeck@co.fillmore.mn.us>
Sent: Monday, October 16, 2017 7:04 PM
To: Jerome Illg (cityoffice@harmony.mn.us)
Subject: Hazard Mitigation Plan Adoption
Attachments: Harmony.docx; FEMA Approval Letter.pdf; Fillmore County Crosswalk 2017.pdf

Mayor, City Council & City Administrator,

We have been working on our Fillmore County All Hazards Mitigation Plan for the past year and a half. We are now in the last stage of getting the final approval from FEMA on our new revised plan. FEMA and the Minnesota HSEM have already approved our Fillmore County All Hazards Mitigation Plan pending adoption.

The last part that we need to complete before FEMA gives us the final approval is to have each City within Fillmore County adopt our plan with a resolution from each City Council. After FEMA receives all the resolutions they will give us final approve of our plan. I have included a Microsoft Word document with a sample resolution that came from a template provided by FEMA that just replaces your City name within the resolution. Will you please copy the attached resolution and place it on your city letterhead and add it to your next city council agenda for approval/adoption. Keep in mind that you are not obligated to be part of our county plan. But be advised that if you choose not to be involved by adopting the resolution, this would mean that in the future if any mitigation funding becomes available or if you have any damages from flooding or natural disasters, you would not qualify for State or FEMA reimbursements. In our past Hazard Mitigation Plans, your city has participated and adopted the resolution to be part of our county plan.

If you have any questions or concerns please let me know, otherwise please email back the adopted resolution as soon as possible.

Thank you.....Kevin

Also, the new Fillmore County Emergency Management Director is Don Kullot. He will be your new contact if you have any emergency management questions. His contact information is below; please keep this for future use to contact him directly.

Don Kullot
901 Houston Street NW
Preston, MN 55965
507-765-2830 (desk)
dkullot@co.fillmore.mn.us

Thank you
Kevin

KEVIN BECK | CHIEF DEPUTY SHERIFF
FILLMORE COUNTY SHERIFF'S OFFICE |
901 HOUSTON STREET NW, PRESTON, MN 55965
507-765-2847 (DESK) | 507-273-4909 (CELL)
507-765-3874 (DISPATCH) | kbeck@co.fillmore.mn.us



FEMA

AUG 01 2017

Ms. Jennifer Nelson
Homeland Security and Emergency Management
Minnesota Department of Public Safety
444 Cedar Street, Suite 223
Saint Paul, MN 55101

Dear Ms. Nelson:

Thank you for submitting the Fillmore County All Hazards Mitigation Plan update for our review. The plan was reviewed based on the local plan criteria contained in 44 CFR Part 201, as authorized by the Disaster Mitigation Act of 2000. Fillmore County met the required criteria for a multi-jurisdictional local hazard mitigation plan. Formal approval of this plan is contingent upon the adoptions by the participating jurisdictions. Once FEMA Region V receives documentation of adoption from the county and other jurisdictions, we will send a letter of official approval to your office.

We look forward to receiving the adoption documentation and completing the approval process for Fillmore County.

If you or the community representatives have any questions, please contact Christine Meissner at (312) 408-4460 or at christine.meissner@fema.dhs.gov.

Sincerely,

A handwritten signature in cursive script, appearing to read "Melissa A. Jansen", is written over the typed name of Mark J. Peterson.

Mark J. Peterson, Acting Director
Mitigation Division

Attachments: Local Plan Review Sheets

APPENDIX A: LOCAL MITIGATION PLAN REVIEW TOOL

The *Local Mitigation Plan Review Tool* demonstrates how the Local Mitigation Plan meets the regulation in 44 CFR §201.6 and offers States and FEMA Mitigation Planners an opportunity to provide feedback to the community.

- The Regulation Checklist provides a summary of FEMA's evaluation of whether the Plan has addressed all requirements.
- The Plan Assessment identifies the plan's strengths as well as documents areas for future improvement.
- The Multi-jurisdiction Summary Sheet is an optional worksheet that can be used to document how each jurisdiction met the requirements of the each Element of the Plan (Planning Process; Hazard Identification and Risk Assessment; Mitigation Strategy; Plan Review, Evaluation, and Implementation; and Plan Adoption).

The FEMA Mitigation Planner must reference this *Local Mitigation Plan Review Guide* when completing the *Local Mitigation Plan Review Tool*.

Jurisdiction: Fillmore County	Title of Plan: Fillmore County Mitigation Plan	Date of Plan: 2017
Local Point of Contact: Kevin Beck		Address: 901 Houston Street NW Preston, MN 55965
Title: Emergency Management Director		
Agency: Fillmore County		
Phone Number: (507) 765-3874		E-Mail:

State Reviewer: Jennifer Nelson	Title: SHMO	Date: 06/26/17
---	-----------------------	--------------------------

FEMA Reviewer: Christine Meissner	Title: Mitigation Planner	Date: 08/1/17
Date Received in FEMA Region (insert #)	06/26/17	
Plan Not Approved		
Plan Approvable Pending Adoption	X	
Plan Approved		

SECTION 1: REGULATION CHECKLIST

INSTRUCTIONS: The Regulation Checklist must be completed by FEMA. The purpose of the Checklist is to identify the location of relevant or applicable content in the Plan by Element/sub-element and to determine if

each requirement has been 'Met' or 'Not Met.' The 'Required Revisions' summary at the bottom of each Element must be completed by FEMA to provide a clear explanation of the revisions that are required for plan approval. Required revisions must be explained for each plan sub-element that is 'Not Met.' Sub-elements should be referenced in each summary by using the appropriate numbers (A1, B3, etc.), where applicable. Requirements for each Element and sub-element are described in detail in this *Plan Review Guide* in Section 4, Regulation Checklist.

1. REGULATION CHECKLIST		Location in Plan (section and/or page number)	Met	Not Met
Regulation (44 CFR 201.6 Local Mitigation Plans)				
ELEMENT A. PLANNING PROCESS				
A1. Does the Plan document the planning process, including how it was prepared and who was involved in the process for each jurisdiction? (Requirement §201.6(c)(1))	Pg. 19-22: Fillmore County EM and RDC contractor spearheaded plan update with a taskforce made up of county and municipal representatives. Meetings convened Aug 2015-July 2016. Appendix: Meeting announcements, affidavit of publication, newspaper clipping, meeting agendas, sign-in sheets, survey materials.	x		
A2. Does the Plan document an opportunity for neighboring communities, local and regional agencies involved in hazard mitigation activities, agencies that have the authority to regulate development as well as other interests to be involved in the planning process? (Requirement §201.6(b)(2))	Pg. 19-22: School districts and utility cooperatives participated in planning taskforce. Appendix: Meeting announcements, affidavit of publication, newspaper clipping, meeting agendas, sign-in sheets, survey materials.	x		
A3. Does the Plan document how the public was involved in the planning process during the drafting stage? (Requirement §201.6(b)(1))	Pg. 19-22: four out of the six meetings convened were opened to the public. Appendix: Meeting announcements, affidavit of publication, newspaper clipping, meeting agendas, sign-in sheets, survey materials.	x		
A4. Does the Plan describe the review and incorporation of existing plans, studies, reports, and technical information? (Requirement §201.6(b)(3))	Pg.22: Technical data/information referenced for plan development. Bibliography included.	x		
A5. Is there discussion of how the community(ies) will continue public participation in the plan maintenance process? (Requirement §201.6(c)(4)(iii))	Pg. 139: Plan will be maintained on the Fillmore County EM website and public notice provided for all annual review meetings.	x		
A6. Is there a description of the method and schedule for keeping the plan current (monitoring, evaluating and updating the mitigation plan within a 5-year cycle)? (Requirement §201.6(c)(4)(i))	Pg. 138-139: Fillmore County EM will have primary responsibility to monitor the plan throughout 5 year lifecycle. Will hold public annual review meeting with the stakeholder taskforce and special meetings after significant hazard events that impact the planning area.	x		
ELEMENT A: REQUIRED REVISIONS				

1. REGULATION CHECKLIST		Location in Plan (section and/or page number)	Met	Not Met
Regulation (44 CFR 201.6 Local Mitigation Plans)				
ELEMENT B. HAZARD IDENTIFICATION AND RISK ASSESSMENT				
B1. Does the Plan include a description of the type, location, and extent of all natural hazards that can affect each jurisdiction(s)? (Requirement §201.6(c)(2)(i))	Pg. 50-117: Natural hazards profiled—severe storms, tornadoes, extreme temps, flood, landslides, and dam/levee failure.	x		
B2. Does the Plan include information on previous occurrences of hazard events and on the probability of future hazard events for each jurisdiction? (Requirement §201.6(c)(2)(i))	Pg. 50-117: Previous occurrences and major declarations discussed. Pg. 108-117: Probability factored in for CPRI rating. Appendix 9: NCDC data	x		
B3. Is there a description of each identified hazard's impact on the community as well as an overall summary of the community's vulnerability for each jurisdiction? (Requirement §201.6(c)(2)(ii))	Pg. 33-48: Vulnerability assessment-- inventory of critical facilities in planning area and replacement values provided. Pg. 108-117: Additional vulnerability assessment included for CPRI ratings. Pg. 50-117: Vulnerability analysis for each hazard Appendix: Depth grids from RiskMAP	x		
B4. Does the Plan address NFIP insured structures within the jurisdiction that have been repetitively damaged by floods? (Requirement §201.6(c)(2)(ii))	Pg. 119-120: Discussion on community RPL structures.	x		
ELEMENT B: REQUIRED REVISIONS				
ELEMENT C. MITIGATION STRATEGY				
C1. Does the plan document each jurisdiction's existing authorities, policies, programs and resources and its ability to expand on and improve these existing policies and programs? (Requirement §201.6(c)(3))	Pg. 119-122: Discussion of community programs, policies, procedures—ex: ARMER radio system, CodeRED, NFIP enforcement, and crosswalk of various plans and ordinances.	x		
C2. Does the Plan address each jurisdiction's participation in the NFIP and continued compliance with NFIP requirements, as appropriate? (Requirement §201.6(c)(3)(ii))	Pg. 119-120: Discussion on community NFIP participation.	x		

1. REGULATION CHECKLIST		Location in Plan (section and/or page number)	Met	Not Met
Regulation (44 CFR 201.6 Local Mitigation Plans)				
C3. Does the Plan include goals to reduce/avoid long-term vulnerabilities to the identified hazards? (Requirement §201.6(c)(3)(i))	Pg. 123-127: Reduce deaths, injuries, property loss and economic disruption due to floods, tornados, landslides, severe storms, extreme temperatures, fires, and dam/levee failure. Within each hazard goal, objectives were included categorized by prevention, property reduction, public education/awareness, natural resource protection, emergency services, and structural projects.	x		
C4. Does the Plan identify and analyze a comprehensive range of specific mitigation actions and projects for each jurisdiction being considered to reduce the effects of hazards, with emphasis on new and existing buildings and infrastructure? (Requirement §201.6(c)(3)(ii))	Pg. 127-136: County-level and jurisdiction-specific mitigation actions ranging in construction and non-construction projects.	x		
C5. Does the Plan contain an action plan that describes how the actions identified will be prioritized (including cost benefit review), implemented, and administered by each jurisdiction? (Requirement §201.6(c)(3)(iv)); (Requirement §201.6(c)(3)(iii))	Pg. 127-129: STAPLEE criteria used for prioritizing actions. Other major influencing factors were project cost/availability of funding and probability/impact of highest ranking hazards.	x		
C6. Does the Plan describe a process by which local governments will integrate the requirements of the mitigation plan into other planning mechanisms, such as comprehensive or capital improvement plans, when appropriate? (Requirement §201.6(c)(4)(ii))	Pg. 138-139: Plans states county and municipal officials will be responsible for integrating the hazard mitigation plan into other relevant plans and policy documents.	x		
ELEMENT C: REQUIRED REVISIONS				
ELEMENT D. PLAN REVIEW, EVALUATION, AND IMPLEMENTATION (applicable to plan updates only)				
D1. Was the plan revised to reflect changes in development? (Requirement §201.6(d)(3))	Pg. 48: Plan states the geographic location of hazards will be considered for future land use and development trends, except where hazards are county-wide. And future development will consider mitigation as planning efforts are better integrated.	x		
D2. Was the plan revised to reflect progress in local mitigation efforts? (Requirement §201.6(d)(3))	Appendix: Table of mitigation actions from 2008 plan with status	x		
D3. Was the plan revised to reflect changes in priorities? (Requirement §201.6(d)(3))	Pg. 127-136: Updated mitigation action table reflects prioritized actions.	x		
ELEMENT D: REQUIRED REVISIONS				

1. REGULATION CHECKLIST		Location in Plan (section and/or page number)	Met	Not Met
Regulation (44 CFR 201.6 Local Mitigation Plans)				
ELEMENT E. PLAN ADOPTION				
E1. Does the Plan include documentation that the plan has been formally adopted by the governing body of the jurisdiction requesting approval? (Requirement §201.6(c)(5))	Pending			
E2. For multi-jurisdictional plans, has each jurisdiction requesting approval of the plan documented formal plan adoption? (Requirement §201.6(c)(5))	Pending			
ELEMENT E: REQUIRED REVISIONS				
ELEMENT F. ADDITIONAL STATE REQUIREMENTS (OPTIONAL FOR STATE REVIEWERS ONLY; NOT TO BE COMPLETED BY FEMA)				
F1.				
F2.				
ELEMENT F: REQUIRED REVISIONS				



1000 Bishops Gate Blvd. Ste 300
Mt. Laurel, NJ 08054-5404

t1.800.444.4554 Opt.2
f1.800.777.3929

August 28, 2017

Mr. Steve Donney, Mayor
Harmony FPSA
225 3rd Ave SW
Harmony, Minnesota, 55939

RE: Harmony Fpsa, Winneshiek County, Iowa, Fillmore County, Minnesota
Public Protection Classification: 06/6Y
Effective Date: December 01, 2017

Dear Mr. Steve Donney,

We wish to thank you for your cooperation during our recent Public Protection Classification (PPC) survey. ISO has completed its analysis of the structural fire suppression delivery system provided in your community. The resulting classification is indicated above.

If you would like to know more about your community's PPC classification, or if you would like to learn about the potential effect of proposed changes to your fire suppression delivery system, please call us at the phone number listed below.

ISO's Public Protection Classification Program (PPC) plays an important role in the underwriting process at insurance companies. In fact, most U.S. insurers – including the largest ones – use PPC information as part of their decision-making when deciding what business to write, coverage's to offer or prices to charge for personal or commercial property insurance.

Each insurance company independently determines the premiums it charges its policyholders. The way an insurer uses ISO's information on public fire protection may depend on several things – the company's fire-loss experience, ratemaking methodology, underwriting guidelines, and its marketing strategy.

Through ongoing research and loss experience analysis, we identified additional differentiation in fire loss experience within our PPC program, which resulted in the revised classifications. We based the differing fire loss experience on the fire suppression capabilities of each community. The new classifications will improve the predictive value for insurers while benefiting both commercial and residential property owners. We've published the new classifications as "X" and "Y" – formerly the "9" and "8B" portion of the split classification, respectively. For example:

- A community currently graded as a split 6/9 classification will now be a split 6/6X classification; with the "6X" denoting what was formerly classified as "9."
- Similarly, a community currently graded as a split 6/8B classification will now be a split 6/6Y classification, the "6Y" denoting what was formerly classified as "8B."

- Communities graded with single “9” or “8B” classifications will remain intact.
- Properties over 5 road miles from a recognized fire station would receive a class 10.

PPC is important to communities and fire departments as well. Communities whose PPC improves may get lower insurance prices. PPC also provides fire departments with a valuable benchmark, and is used by many departments as a valuable tool when planning, budgeting and justifying fire protection improvements.

ISO appreciates the high level of cooperation extended by local officials during the entire PPC survey process. The community protection baseline information gathered by ISO is an essential foundation upon which determination of the relative level of fire protection is made using the Fire Suppression Rating Schedule.

The classification is a direct result of the information gathered, and is dependent on the resource levels devoted to fire protection in existence at the time of survey. Material changes in those resources that occur after the survey is completed may affect the classification. Although ISO maintains a pro-active process to keep baseline information as current as possible, in the event of changes please call us at 1-800-444-4554, option 2 to expedite the update activity.

ISO is the leading supplier of data and analytics for the property/casualty insurance industry. Most insurers use PPC classifications for underwriting and calculating premiums for residential, commercial and industrial properties. The PPC program is not intended to analyze all aspects of a comprehensive structural fire suppression delivery system program. It is not for purposes of determining compliance with any state or local law, nor is it for making loss prevention or life safety recommendations.

If you have any questions about your classification, please let us know.

Sincerely,

Alex Shubert

Alex Shubert
Manager -National Processing Center

cc: Mr. Rod Johnson, Chief, Harmony Fire Department
Mr. Leroy Eickoff, Chief Dispatcher, Fillmore County Sheriff Dispatch
Mr. Brian Johnson, Water Superintendent, Harmony Water Department

**Public Protection Classification
(PPC™)
Summary Report**

Harmony FPSA

IOWA

Prepared by

**Insurance Services Office, Inc.
1000 Bishops Gate Blvd., Ste. 300
P.O. Box 5404
Mt. Laurel, New Jersey 08054-5404
1-800-444-4554**

**Report Created August 2017
Effective December 1, 2017**

Background Information

Introduction

ISO collects and evaluates information from communities in the United States on their structure fire suppression capabilities. The data is analyzed using our Fire Suppression Rating Schedule (FSRS) and then a Public Protection Classification (PPC™) grade is assigned to the community. The surveys are conducted whenever it appears that there is a possibility of a PPC change. As such, the PPC program provides important, up-to-date information about fire protection services throughout the country.

The FSRS recognizes fire protection features only as they relate to suppression of first alarm structure fires. In many communities, fire suppression may be only a small part of the fire department's overall responsibility. ISO recognizes the dynamic and comprehensive duties of a community's fire service, and understands the complex decisions a community must make in planning and delivering emergency services. However, in developing a community's PPC grade, only features related to reducing property losses from structural fires are evaluated. Multiple alarms, simultaneous incidents and life safety are not considered in this evaluation. The PPC program evaluates the fire protection for small to average size buildings. Specific properties with a Needed Fire Flow in excess of 3,500 gpm are evaluated separately and assigned an individual PPC grade.

A community's investment in fire mitigation is a proven and reliable predictor of future fire losses. Statistical data on insurance losses bears out the relationship between excellent fire protection – as measured by the PPC program – and low fire losses. So, insurance companies use PPC information for marketing, underwriting, and to help establish fair premiums for homeowners and commercial fire insurance. In general, the price of fire insurance in a community with a good PPC grade is substantially lower than in a community with a poor PPC grade, assuming all other factors are equal.

ISO is an independent company that serves insurance companies, communities, fire departments, insurance regulators, and others by providing information about risk. ISO's expert staff collects information about municipal fire suppression efforts in communities throughout the United States. In each of those communities, ISO analyzes the relevant data and assigns a PPC grade – a number from 1 to 10. Class 1 represents an exemplary fire suppression program, and Class 10 indicates that the area's fire suppression program does not meet ISO's minimum criteria.

ISO's PPC program evaluates communities according to a uniform set of criteria, incorporating nationally recognized standards developed by the National Fire Protection Association and the American Water Works Association. A community's PPC grade depends on:

- **Needed Fire Flows**, which are representative building locations used to determine the theoretical amount of water necessary for fire suppression purposes.
- **Emergency Communications**, including emergency reporting, telecommunicators, and dispatching systems.
- **Fire Department**, including equipment, staffing, training, geographic distribution of fire companies, operational considerations, and community risk reduction.
- **Water Supply**, including inspection and flow testing of hydrants, alternative water supply operations, and a careful evaluation of the amount of available water compared with the amount needed to suppress fires up to 3,500 gpm.

Data Collection and Analysis

ISO has evaluated and classified over 46,000 fire protection areas across the United States using its FSRS. A combination of meetings between trained ISO field representatives and the dispatch center coordinator, community fire official, and water superintendent is used in conjunction with a comprehensive questionnaire to collect the data necessary to determine the PPC grade. In order for a community to obtain a grade better than a Class 9, three elements of fire suppression features are reviewed. These three elements are Emergency Communications, Fire Department, and Water Supply.

A review of the **Emergency Communications** accounts for 10% of the total classification. This section is weighted at **10 points**, as follows:

- Emergency Reporting 3 points
- Telecommunicators 4 points
- Dispatch Circuits 3 points

A review of the **Fire Department** accounts for 50% of the total classification. ISO focuses on a fire department's first alarm response and initial attack to minimize potential loss. The fire department section is weighted at **50 points**, as follows:

- Engine Companies 6 points
- Reserve Pumpers 0.5 points
- Pump Capacity 3 points
- Ladder/Service Companies 4 points
- Reserve Ladder/Service Trucks 0.5 points
- Deployment Analysis 10 points
- Company Personnel 15 points
- Training 9 points
- Operational considerations 2 points
- Community Risk Reduction 5.5 points (in addition to the 50 points above)

A review of the **Water Supply** system accounts for 40% of the total classification. ISO reviews the water supply a community uses to determine the adequacy for fire suppression purposes. The water supply system is weighted at **40 points**, as follows:

- Credit for Supply System 30 points
- Hydrant Size, Type & Installation 3 points
- Inspection & Flow Testing of Hydrants 7 points

There is one additional factor considered in calculating the final score – **Divergence**.

Even the best fire department will be less than fully effective if it has an inadequate water supply. Similarly, even a superior water supply will be less than fully effective if the fire department lacks the equipment or personnel to use the water. The FSRS score is subject to modification by a divergence factor, which recognizes disparity between the effectiveness of the fire department and the water supply.

The Divergence factor mathematically reduces the score based upon the relative difference between the fire department and water supply scores. The factor is introduced in the final equation.

PPC Grade

The PPC grade assigned to the community will depend on the community's score on a 100-point scale:

PPC	Points
1	90.00 or more
2	80.00 to 89.99
3	70.00 to 79.99
4	60.00 to 69.99
5	50.00 to 59.99
6	40.00 to 49.99
7	30.00 to 39.99
8	20.00 to 29.99
9	10.00 to 19.99
10	0.00 to 9.99

The classification numbers are interpreted as follows:

- Class 1 through (and including) Class 8 represents a fire suppression system that includes an FSRS creditable dispatch center, fire department, and water supply.
- Class 8B is a special classification that recognizes a superior level of fire protection in otherwise Class 9 areas. It is designed to represent a fire protection delivery system that is superior except for a lack of a water supply system capable of the minimum FSRS fire flow criteria of 250 gpm for 2 hours.
- Class 9 is a fire suppression system that includes a creditable dispatch center, fire department but no FSRS creditable water supply.
- Class 10 does not meet minimum FSRS criteria for recognition, including areas that are beyond five road miles of a recognized fire station.

New PPC program changes effective July 1, 2014

We have revised the PPC program to capture the effects of enhanced fire protection capabilities that reduce fire loss and fire severity in Split Class 9 and Split Class 8B areas (as outlined below). This new structure benefits the fire service, community, and property owner.

New classifications

Through ongoing research and loss experience analysis, we identified additional differentiation in fire loss experience within our PPC program, which resulted in the revised classifications. We based the differing fire loss experience on the fire suppression capabilities of each community. The new PPC classes will improve the predictive value for insurers while benefiting both commercial and residential property owners. Here are the new classifications and what they mean.

Split classifications

When we develop a split classification for a community — for example 5/9 — the first number is the class that applies to properties within 5 road miles of the responding fire station and 1,000 feet of a creditable water supply, such as a fire hydrant, suction point, or dry hydrant. The second number is the class that applies to properties within 5 road miles of a fire station but beyond 1,000 feet of a creditable water supply. We have revised the classification to reflect more precisely the risk of loss in a community, replacing Class 9 and 8B in the second part of a split classification with revised designations.

What's changed with the new classifications?

We've published the new classifications as "X" and "Y" — formerly the "9" and "8B" portion of the split classification, respectively. For example:

- A community currently displayed as a split 6/9 classification will now be a split 6/6X classification; with the "6X" denoting what was formerly classified as "9".
- Similarly, a community currently graded as a split 6/8B classification will now be a split 6/6Y classification, the "6Y" denoting what was formerly classified as "8B".
- Communities graded with single "9" or "8B" classifications will remain intact.

Prior Classification	New Classification
1/9	1/1X
2/9	2/2X
3/9	3/3X
4/9	4/4X
5/9	5/5X
6/9	6/6X
7/9	7/7X
8/9	8/8X
9	9

Prior Classification	New Classification
1/8B	1/1Y
2/8B	2/2Y
3/8B	3/3Y
4/8B	4/4Y
5/8B	5/5Y
6/8B	6/6Y
7/8B	7/7Y
8/8B	8/8Y
8B	8B

What's changed?

As you can see, we're still maintaining split classes, but it's how we represent them to insurers that's changed. The new designations reflect a reduction in fire severity and loss and have the potential to reduce property insurance premiums.

Benefits of the revised split class designations

- To the fire service, the revised designations identify enhanced fire suppression capabilities used throughout the fire protection area
- To the community, the new classes reward a community's fire suppression efforts by showing a more reflective designation
- To the individual property owner, the revisions offer the potential for decreased property insurance premiums

New water class

Our data also shows that risks located more than 5 but less than 7 road miles from a responding fire station with a creditable water source within 1,000 feet had better loss experience than those farther than 5 road miles from a responding fire station with no creditable water source. We've introduced a new classification —10W— to recognize the reduced loss potential of such properties.

What's changed with Class 10W?

Class 10W is property-specific. Not all properties in the 5-to-7-mile area around the responding fire station will qualify. The difference between Class 10 and 10W is that the 10W-graded risk or property is within 1,000 feet of a creditable water supply. Creditable water supplies include fire protection systems using hauled water in any of the split classification areas.

What's the benefit of Class 10W?

10W gives credit to risks within 5 to 7 road miles of the responding fire station and within 1,000 feet of a creditable water supply. That's reflective of the potential for reduced property insurance premiums.

What does the fire chief have to do?

Fire chiefs don't have to do anything at all. The revised classifications went in place automatically effective July 1, 2014 (July 1, 2015 for Texas).

What if I have additional questions?

Feel free to contact ISO at 800.444.4554 or email us at PPC-Cust-Serv@iso.com.

Distribution of PPC Grades

The 2017 published countrywide distribution of communities by the PPC grade is as follows:

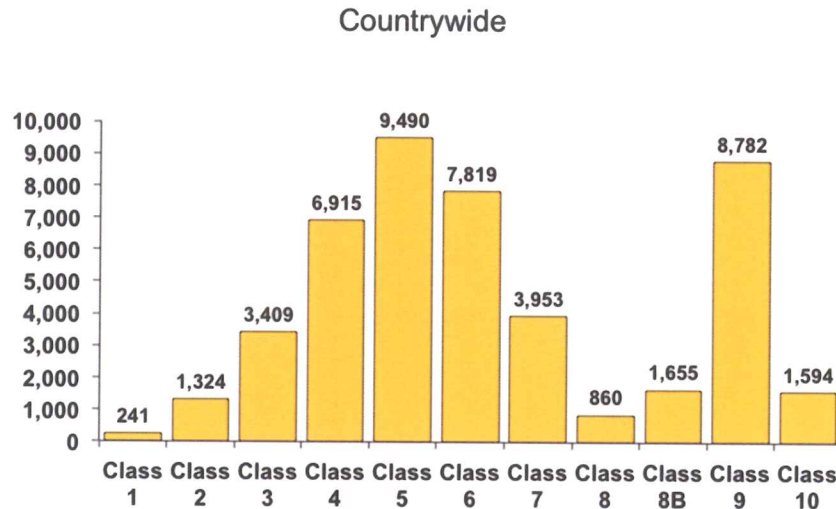

Assistance

The PPC program offers help to communities, fire departments, and other public officials as they plan for, budget, and justify improvements. ISO is also available to assist in the understanding of the details of this evaluation.

The PPC program representatives can be reached by telephone at (800) 444-4554. The technical specialists at this telephone number have access to the details of this evaluation and can effectively speak with you about your questions regarding the PPC program. What's more, we can be reached via the internet at www.isomitigation.com/talk/.

We also have a website dedicated to our Community Hazard Mitigation Classification programs at www.isomitigation.com. Here, fire chiefs, building code officials, community leaders and other interested citizens can access a wealth of data describing the criteria used in evaluating how cities and towns are protecting residents from fire and other natural hazards. This website will allow you to learn more about the PPC program. The website provides important background information, insights about the PPC grading processes and technical documents. ISO is also pleased to offer Fire Chiefs Online — a special, secured website with information and features that can help improve your PPC grade, including a list of the Needed Fire Flows for all the commercial occupancies ISO has on file for your community. Visitors to the site can download information, see statistical results and also contact ISO for assistance.

In addition, on-line access to the FSRs and its commentaries is available to registered customers for a fee. However, fire chiefs and community chief administrative officials are given access privileges to this information without charge.

To become a registered fire chief or community chief administrative official, register at www.isomitigation.com.

PPC Review

ISO concluded its review of the fire suppression features being provided for Harmony FPSA. The resulting community classification is **Class 06/6Y**.

If the classification is a single class, the classification applies to properties with a Needed Fire Flow of 3,500 gpm or less in the community. If the classification is a split class (e.g., 6/XX):

- The first class (e.g., "6" in a 6/XX) applies to properties within 5 road miles of a recognized fire station and within 1,000 feet of a fire hydrant or alternate water supply.
- The second class (XX or XY) applies to properties beyond 1,000 feet of a fire hydrant but within 5 road miles of a recognized fire station.
- Alternative Water Supply: The first class (e.g., "6" in a 6/10) applies to properties within 5 road miles of a recognized fire station with no hydrant distance requirement.
- Class 10 applies to properties over 5 road miles of a recognized fire station.
- Class 10W applies to properties within 5 to 7 road miles of a recognized fire station with a recognized water supply within 1,000 feet.
- Specific properties with a Needed Fire Flow in excess of 3,500 gpm are evaluated separately and assigned an individual classification.

FIRS Feature	Earned Credit	Credit Available
Emergency Communications		
414. Credit for Emergency Reporting	1.95	3
422. Credit for Telecommunicators	2.42	4
432. Credit for Dispatch Circuits	1.95	3
440. Credit for Emergency Communications	6.32	10
Fire Department		
513. Credit for Engine Companies	3.45	6
523. Credit for Reserve Pumpers	0.00	0.50
532. Credit for Pump Capacity	2.25	3
549. Credit for Ladder Service	2.69	4
553. Credit for Reserve Ladder and Service Trucks	0.00	0.50
561. Credit for Deployment Analysis	7.87	10
571. Credit for Company Personnel	3.67	15
581. Credit for Training	1.32	9
730. Credit for Operational Considerations	2.00	2
590. Credit for Fire Department	23.25	50
Water Supply		
616. Credit for Supply System	8.46	30
621. Credit for Hydrants	2.28	3
631. Credit for Inspection and Flow Testing	3.20	7
640. Credit for Water Supply	13.94	40
Divergence	-2.33	--
1050. Community Risk Reduction	2.37	5.50
Total Credit	43.55	105.50

Emergency Communications

Ten percent of a community's overall score is based on how well the communications center receives and dispatches fire alarms. Our field representative evaluated:

- Communications facilities provided for the general public to report structure fires
- Enhanced 9-1-1 Telephone Service including wireless
- Computer-aided dispatch (CAD) facilities
- Alarm receipt and processing at the communication center
- Training and certification of telecommunicators
- Facilities used to dispatch fire department companies to reported structure fires

	Earned Credit	Credit Available
414. Credit Emergency Reporting	1.95	3
422. Credit for Telecommunicators	2.42	4
432. Credit for Dispatch Circuits	1.95	3
Item 440. Credit for Emergency Communications:	6.32	10

Item 414 - Credit for Emergency Reporting (3 points)

The first item reviewed is Item 414 "Credit for Emergency Reporting (CER)". This item reviews the emergency communication center facilities provided for the public to report fires including 911 systems (Basic or Enhanced), Wireless Phase I and Phase II, Voice over Internet Protocol, Computer Aided Dispatch and Geographic Information Systems for automatic vehicle location. ISO uses National Fire Protection Association (NFPA) 1221, *Standard for the Installation, Maintenance and Use of Emergency Services Communications Systems* as the reference for this section.

Item 410. Emergency Reporting (CER)	Earned Credit	Credit Available
A./B. Basic 9-1-1, Enhanced 9-1-1 or No 9-1-1 For maximum credit, there should be an Enhanced 9-1-1 system, Basic 9-1-1 and No 9-1-1 will receive partial credit.	20.00	20
1. E9-1-1 Wireless Wireless Phase I using Static ALI (automatic location identification) Functionality (10 points); Wireless Phase II using Dynamic ALI Functionality (15 points); Both available will be 25 points	10.00	25
2. E9-1-1 Voice over Internet Protocol (VoIP) Static VoIP using Static ALI Functionality (10 points); Nomadic VoIP using Dynamic ALI Functionality (15 points); Both available will be 25 points	10.00	25
3. Computer Aided Dispatch Basic CAD (5 points); CAD with Management Information System (5 points); CAD with Interoperability (5 points)	10.00	15
4. Geographic Information System (GIS/AVL) <u>The PSAP uses a fully integrated CAD/GIS management system with automatic vehicle location (AVL) integrated with a CAD system providing dispatch assignments.</u> The individual fire departments being dispatched <u>do not</u> need GIS/AVL capability to obtain this credit.	15.00	15
Review of Emergency Reporting total:	65.00	100

Item 422- Credit for Telecommunicators (4 points)

The second item reviewed is Item 422 "Credit for Telecommunicators (TC)". This item reviews the number of Telecommunicators on duty at the center to handle fire calls and other emergencies. All emergency calls including those calls that do not require fire department action are reviewed to determine the proper staffing to answer emergency calls and dispatch the appropriate emergency response. The 2013 Edition of NFPA 1221, *Standard for the Installation, Maintenance and Use of Emergency Services Communications Systems*, recommends that ninety-five percent of emergency calls shall be answered within 15 seconds and ninety-nine percent of emergency calls shall be answered within 40 seconds. In addition, NFPA recommends that eighty percent of emergency alarm processing shall be completed within 60 seconds and ninety-five percent of alarm processing shall be completed within 106 seconds of answering the call.

To receive full credit for operators on duty, ISO must review documentation to show that the communication center meets NFPA 1221 call answering and dispatch time performance measurement standards. This documentation may be in the form of performance statistics or other performance measurements compiled by the 9-1-1 software or other software programs that are currently in use such as Computer Aided Dispatch (CAD) or Management Information System (MIS).

Item 420. Telecommunicators (CTC)	Earned Credit	Credit Available
A1. Alarm Receipt (AR) Receipt of alarms shall meet the requirements in accordance with the criteria of NFPA 1221	20.00	20
A2. Alarm Processing (AP) Processing of alarms shall meet the requirements in accordance with the criteria of NFPA 1221	0.53	20
B. Emergency Dispatch Protocols (EDP) Telecommunicators have emergency dispatch protocols (EDP) containing questions and a decision-support process to facilitate correct call categorization and prioritization.	0.00	20
C. Telecommunicator Training and Certification (TTC) Telecommunicators meet the qualification requirements referenced in NFPA 1061, <i>Standard for Professional Qualifications for Public Safety Telecommunicator</i> , and/or the Association of Public-Safety Communications Officials - International (APCO) <i>Project 33</i> . Telecommunicators are certified in the knowledge, skills, and abilities corresponding to their job functions.	20.00	20
D. Telecommunicator Continuing Education and Quality Assurance (TQA) Telecommunicators participate in continuing education and/or in-service training and quality-assurance programs as appropriate for their positions	20.00	20
Review of Telecommunicators total:	60.53	100

Item 432 - Credit for Dispatch Circuits (3 points)

The third item reviewed is Item 432 "Credit for Dispatch Circuits (CDC)". This item reviews the dispatch circuit facilities used to transmit alarms to fire department members. A "Dispatch Circuit" is defined in NFPA 1221 as "A circuit over which an alarm is transmitted from the communications center to an emergency response facility (ERF) or emergency response units (ERUs) to notify ERUs to respond to an emergency". All fire departments (except single fire station departments with full-time firefighter personnel receiving alarms directly at the fire station) need adequate means of notifying all firefighter personnel of the location of reported structure fires. The dispatch circuit facilities should be in accordance with the general criteria of NFPA 1221. "Alarms" are defined in this Standard as "A signal or message from a person or device indicating the existence of an emergency or other situation that requires action by an emergency response agency".

There are two different levels of dispatch circuit facilities provided for in the Standard – a primary dispatch circuit and a secondary dispatch circuit. In jurisdictions that receive 730 alarms or more per year (average of two alarms per 24-hour period), two separate and dedicated dispatch circuits, a primary and a secondary, are needed. In jurisdictions receiving fewer than 730 alarms per year, a second dedicated dispatch circuit is not needed. Dispatch circuit facilities installed but not used or tested (in accordance with the NFPA Standard) receive no credit.

The score for Credit for Dispatch Circuits (CDC) is influenced by monitoring for integrity of the primary dispatch circuit. There are up to 0.90 points available for this Item. Monitoring for integrity involves installing automatic systems that will detect faults and failures and send visual and audible indications to appropriate communications center (or dispatch center) personnel. ISO uses NFPA 1221 to guide the evaluation of this item. ISO's evaluation also includes a review of the communication system's emergency power supplies.

Item 432 "Credit for Dispatch Circuits (CDC)" = 1.95 points

Fire Department

Fifty percent of a community's overall score is based upon the fire department's structure fire suppression system. ISO's field representative evaluated:

- Engine and ladder/service vehicles including reserve apparatus
- Equipment carried
- Response to reported structure fires
- Deployment analysis of companies
- Available and/or responding firefighters
- Training

	Earned Credit	Credit Available
513. Credit for Engine Companies	3.45	6
523. Credit for Reserve Pumps	0.00	0.5
532. Credit for Pumper Capacity	2.25	3
549. Credit for Ladder Service	2.69	4
553. Credit for Reserve Ladder and Service Trucks	0.00	0.5
561. Credit for Deployment Analysis	7.87	10
571. Credit for Company Personnel	3.67	15
581. Credit for Training	1.32	9
730. Credit for Operational Considerations	2.00	2
Item 590. Credit for Fire Department:	23.25	50

Basic Fire Flow

The Basic Fire Flow for the community is determined by the review of the Needed Fire Flows for selected buildings in the community. The fifth largest Needed Fire Flow is determined to be the Basic Fire Flow. The Basic Fire Flow has been determined to be 3000 gpm.

Item 513 - Credit for Engine Companies (6 points)

The first item reviewed is Item 513 "Credit for Engine Companies (CEC)". This item reviews the number of engine companies, their pump capacity, hose testing, pump testing and the equipment carried on the in-service pumpers. To be recognized, pumper apparatus must meet the general criteria of NFPA 1901, *Standard for Automotive Fire Apparatus* which include a minimum 250 gpm pump, an emergency warning system, a 300 gallon water tank, and hose. At least 1 apparatus must have a permanently mounted pump rated at 750 gpm or more at 150 psi.

The review of the number of needed pumpers considers the response distance to built-upon areas; the Basic Fire Flow; and the method of operation. Multiple alarms, simultaneous incidents, and life safety are not considered.

The greatest value of A, B, or C below is needed in the fire district to suppress fires in structures with a Needed Fire Flow of 3,500 gpm or less: **3 engine companies**

- a) **1 engine companies** to provide fire suppression services to areas to meet NFPA 1710 criteria or within 1½ miles.
- b) **3 engine companies** to support a Basic Fire Flow of 3000 gpm.
- c) **3 engine companies** based upon the fire department's method of operation to provide a minimum two engine response to all first alarm structure fires.

The FSRs recognizes that there are **2 engine companies** in service.

The FSRs also reviews Automatic Aid. Automatic Aid is considered in the review as assistance dispatched automatically by contractual agreement between two communities or fire districts. That differs from mutual aid or assistance arranged case by case. ISO will recognize an Automatic Aid plan under the following conditions:

- It must be prearranged for first alarm response according to a definite plan. It is preferable to have a written agreement, but ISO may recognize demonstrated performance.
- The aid must be dispatched to all reported structure fires on the initial alarm.
- The aid must be provided 24 hours a day, 365 days a year.

FSRS Item 512.D "Automatic Aid Engine Companies" responding on first alarm and meeting the needs of the city for basic fire flow and/or distribution of companies are factored based upon the value of the Automatic Aid plan (up to 1.00 can be used as the factor). The Automatic Aid factor is determined by a review of the Automatic Aid provider's communication facilities, how they receive alarms from the graded area, inter-department training between fire departments, and the fire ground communications capability between departments.

For each engine company, the credited Pump Capacity (PC), the Hose Carried (HC), the Equipment Carried (EC) all contribute to the calculation for the percent of credit the FSRs provides to that engine company.

Item 513 "Credit for Engine Companies (CEC)" = 3.45 points

Item 523 - Credit for Reserve Pumpers (0.50 points)

The item is Item 523 "Credit for Reserve Pumpers (CRP)". This item reviews the number and adequacy of the pumpers and their equipment. The number of needed reserve pumpers is 1 for each 8 needed engine companies determined in Item 513, or any fraction thereof.

Item 523 "Credit for Reserve Pumpers (CRP)" = 0.00 points

Item 532 – Credit for Pumper Capacity (3 points)

The next item reviewed is Item 532 "Credit for Pumper Capacity (CPC)". The total pump capacity available should be sufficient for the Basic Fire Flow of 3000 gpm. The maximum needed pump capacity credited is the Basic Fire Flow of the community.

Item 532 "Credit for Pumper Capacity (CPC)" = 2.25 points

Item 549 – Credit for Ladder Service (4 points)

The next item reviewed is Item 549 "Credit for Ladder Service (CLS)". This item reviews the number of response areas within the city with 5 buildings that are 3 or more stories or 35 feet or more in height, or with 5 buildings that have a Needed Fire Flow greater than 3,500 gpm, or any combination of these criteria. The height of all buildings in the city, including those protected by automatic sprinklers, is considered when determining the number of needed ladder companies. Response areas not needing a ladder company should have a service company. Ladders, tools and equipment normally carried on ladder trucks are needed not only for ladder operations but also for forcible entry, ventilation, salvage, overhaul, lighting and utility control.

The number of ladder or service companies, the height of the aerial ladder, aerial ladder testing and the equipment carried on the in-service ladder trucks and service trucks is compared with the number of needed ladder trucks and service trucks and an FSRS equipment list. Ladder trucks must meet the general criteria of NFPA 1901, *Standard for Automotive Fire Apparatus* to be recognized.

The number of needed ladder-service trucks is dependent upon the number of buildings 3 stories or 35 feet or more in height, buildings with a Needed Fire Flow greater than 3,500 gpm, and the method of operation.

The FSRS recognizes that there are **0 ladder companies** in service. These companies are needed to provide fire suppression services to areas to meet NFPA 1710 criteria or within 2½ miles and the number of buildings with a Needed Fire Flow over 3,500 gpm or 3 stories or more in height, or the method of operation.

The FSRS recognizes that there are **1 service companies** in service.

Item 549 "Credit for Ladder Service (CLS)" = 2.69 points

Item 553 – Credit for Reserve Ladder and Service Trucks (0.50 points)

The next item reviewed is Item 553 “Credit for Reserve Ladder and Service Trucks (CRLS)”. This item considers the adequacy of ladder and service apparatus when one (or more in larger communities) of these apparatus are out of service. The number of needed reserve ladder and service trucks is 1 for each 8 needed ladder and service companies that were determined to be needed in Item 540, or any fraction thereof.

Item 553 “Credit for Reserve Ladder and Service Trucks (CRLS)” = 0.00 points

Item 561 – Deployment Analysis (10 points)

Next, Item 561 “Deployment Analysis (DA)” is reviewed. This Item examines the number and adequacy of existing engine and ladder-service companies to cover built-upon areas of the city.

To determine the Credit for Distribution, first the Existing Engine Company (EC) points and the Existing Engine Companies (EE) determined in Item 513 are considered along with Ladder Company Equipment (LCE) points, Service Company Equipment (SCE) points, Engine-Ladder Company Equipment (ELCE) points, and Engine-Service Company Equipment (ESCE) points determined in Item 549.

Secondly, as an alternative to determining the number of needed engine and ladder/service companies through the road-mile analysis, a fire protection area may use the results of a systematic performance evaluation. This type of evaluation analyzes computer-aided dispatch (CAD) history to demonstrate that, with its current deployment of companies, the fire department meets the time constraints for initial arriving engine and initial full alarm assignment in accordance with the general criteria of in NFPA 1710, *Standard for the Organization and Deployment of Fire Suppression Operations, Emergency Medical Operations, and Special Operations to the Public by Career Fire Departments*.

A determination is made of the percentage of built upon area within 1½ miles of a first-due engine company and within 2½ miles of a first-due ladder-service company.

Item 561 “Credit Deployment Analysis (DA)” = 7.87 points

Item 571 – Credit for Company Personnel (15 points)

Item 571 “Credit for Company Personnel (CCP)” reviews the average number of existing firefighters and company officers available to respond to reported first alarm structure fires in the city.

The on-duty strength is determined by the yearly average of total firefighters and company officers on-duty considering vacations, sick leave, holidays, “Kelley” days and other absences. When a fire department operates under a minimum staffing policy, this may be used in lieu of determining the yearly average of on-duty company personnel.

Firefighters on apparatus not credited under Items 513 and 549 that regularly respond to reported first alarms to aid engine, ladder, and service companies are included in this item as increasing the total company strength.

Firefighters staffing ambulances or other units serving the general public are credited if they participate in fire-fighting operations, the number depending upon the extent to which they are available and are used for response to first alarms of fire.

On-Call members are credited on the basis of the average number staffing apparatus on first alarms. Off-shift career firefighters and company officers responding on first alarms are considered on the same basis as on-call personnel. For personnel not normally at the fire station, the number of responding firefighters and company officers is divided by 3 to reflect the time needed to assemble at the fire scene and the reduced ability to act as a team due to the various arrival times at the fire location when compared to the personnel on-duty at the fire station during the receipt of an alarm.

The number of Public Safety Officers who are positioned in emergency vehicles within the jurisdiction boundaries may be credited based on availability to respond to first alarm structure fires. In recognition of this increased response capability the number of responding Public Safety Officers is divided by 2.

The average number of firefighters and company officers responding with those companies credited as Automatic Aid under Items 513 and 549 are considered for either on-duty or on-call company personnel as is appropriate. The actual number is calculated as the average number of company personnel responding multiplied by the value of AA Plan determined in Item 512.D.

The maximum creditable response of on-duty and on-call firefighters is 12, including company officers, for each existing engine and ladder company and 6 for each existing service company.

Chief Officers are not creditable except when more than one chief officer responds to alarms; then extra chief officers may be credited as firefighters if they perform company duties.

The FSRS recognizes **0.00 on-duty personnel** and an average of **11.00 on-call personnel** responding on first alarm structure fires.

Item 571 “Credit for Company Personnel (CCP)” = 3.67 points

Item 581 – Credit for Training (9 points)

Training	Earned Credit	Credit Available
A. Facilities, and Use For maximum credit, each firefighter should receive 18 hours per year in structure fire related subjects as outlined in NFPA 1001.	1.02	35
B. Company Training For maximum credit, each firefighter should receive 16 hours per month in structure fire related subjects as outlined in NFPA 1001.	2.34	25
C. Classes for Officers For maximum credit, each officer should be certified in accordance with the general criteria of NFPA 1021. Additionally, each officer should receive 12 hours of continuing education on or off site.	5.63	12
D. New Driver and Operator Training For maximum credit, each new driver and operator should receive 60 hours of driver/operator training per year in accordance with NFPA 1002 and NFPA 1451.	0.00	5
E. Existing Driver and Operator Training For maximum credit, each existing driver and operator should receive 12 hours of driver/operator training per year in accordance with NFPA 1002 and NFPA 1451.	0.00	5
F. Training on Hazardous Materials For maximum credit, each firefighter should receive 6 hours of training for incidents involving hazardous materials in accordance with NFPA 472.	0.67	1
G. Recruit Training For maximum credit, each firefighter should receive 240 hours of structure fire related training in accordance with NFPA 1001 within the first year of employment or tenure.	5.00	5
H. Pre-Fire Planning Inspections For maximum credit, pre-fire planning inspections of each commercial, industrial, institutional, and other similar type building (all buildings except 1-4 family dwellings) should be made annually by company members. Records of inspections should include up-to date notes and sketches.	0.00	12

Item 580 “Credit for Training (CT)” = 1.32 points

Item 730 – Operational Considerations (2 points)

Item 730 “Credit for Operational Considerations (COC)” evaluates fire department standard operating procedures and incident management systems for emergency operations involving structure fires.

Operational Considerations	Earned Credit	Credit Available
Standard Operating Procedures The department should have established SOPs for fire department general emergency operations	50	50
Incident Management Systems The department should use an established incident management system (IMS)	50	50
Operational Considerations total:	100	100

Item 730 “Credit for Operational Considerations (COC)” = 2.00 points

Water Supply

Forty percent of a community's overall score is based on the adequacy of the water supply system. The ISO field representative evaluated:

- the capability of the water distribution system to meet the Needed Fire Flows at selected locations up to 3,500 gpm.
- size, type and installation of fire hydrants.
- inspection and flow testing of fire hydrants.

	Earned Credit	Credit Available
616. Credit for Supply System	8.46	30
621. Credit for Hydrants	2.28	3
631. Credit for Inspection and Flow Testing	3.20	7
Item 640. Credit for Water Supply:	13.94	40

Item 616 – Credit for Supply System (30 points)

The first item reviewed is Item 616 “Credit for Supply System (CSS)”. This item reviews the rate of flow that can be credited at each of the Needed Fire Flow test locations considering the supply works capacity, the main capacity and the hydrant distribution. The lowest flow rate of these items is credited for each representative location. A water system capable of delivering 250 gpm or more for a period of two hours plus consumption at the maximum daily rate at the fire location is considered minimum in the ISO review.

Where there are 2 or more systems or services distributing water at the same location, credit is given on the basis of the joint protection provided by all systems and services available.

The supply works capacity is calculated for each representative Needed Fire Flow test location, considering a variety of water supply sources. These include public water supplies, emergency supplies (usually accessed from neighboring water systems), suction supplies (usually evidenced by dry hydrant installations near a river, lake or other body of water), and supplies developed by a fire department using large diameter hose or vehicles to shuttle water from a source of supply to a fire site. The result is expressed in gallons per minute (gpm).

The normal ability of the distribution system to deliver Needed Fire Flows at the selected building locations is reviewed. The results of a flow test at a representative test location will indicate the ability of the water mains (or fire department in the case of fire department supplies) to carry water to that location.

The hydrant distribution is reviewed within 1,000 feet of representative test locations measured as hose can be laid by apparatus.

For maximum credit, the Needed Fire Flows should be available at each location in the district. Needed Fire Flows of 2,500 gpm or less should be available for 2 hours; and Needed Fire Flows of 3,000 and 3,500 gpm should be obtainable for 3 hours.

Item 616 “Credit for Supply System (CSS)” = 8.46 points

Item 621 – Credit for Hydrants (3 points)

The second item reviewed is Item 621 “Credit for Hydrants (CH)”. This item reviews the number of fire hydrants of each type compared with the total number of hydrants.

There are a total of 86 hydrants in the graded area.

620. Hydrants, - Size, Type and Installation	Number of Hydrants
A. With a 6 -inch or larger branch and a pumper outlet with or without 2½ - inch outlets	50
B. With a 6 -inch or larger branch and no pumper outlet but two or more 2½ -inch outlets, or with a small foot valve, or with a small barrel	13
C./D. With only a 2½ -inch outlet or with less than a 6 -inch branch	23
E./F. Flush Type, Cistern, or Suction Point	0

Item 621 “Credit for Hydrants (CH)” = 2.28 points

Item 630 – Credit for Inspection and Flow Testing (7 points)

The third item reviewed is Item 630 “Credit for Inspection and Flow Testing (CIT)”. This item reviews the fire hydrant inspection frequency, and the completeness of the inspections. Inspection of hydrants should be in accordance with AWWA M-17, *Installation, Field Testing and Maintenance of Fire Hydrants*.

Frequency of Inspection (FI): Average interval between the 3 most recent inspections.

Frequency	Points
1 year	30
2 years	20
3 years	10
4 years	5
5 years or more	No Credit

Note: The points for inspection frequency are reduced by 10 points if the inspections are incomplete or do not include a flushing program. An additional reduction of 10 points are made if hydrants are not subjected to full system pressure during inspections. If the inspection of cisterns or suction points does not include actual drafting with a pumper, or back-flushing for dry hydrants, 20 points are deducted.

Total points for Inspections = 3.20 points

Frequency of Fire Flow Testing (FF): Average interval between the 3 most recent inspections.

Frequency	Points
5 years	40
6 years	30
7 years	20
8 years	10
9 years	5
10 years or more	No Credit

Total points for Fire Flow Testing = 0.00 points

Item 631 "Credit for Inspection and Fire Flow Testing (CIT)" = 3.20 points

Divergence = -2.33

The Divergence factor mathematically reduces the score based upon the relative difference between the fire department and water supply scores. The factor is introduced in the final equation.

Community Risk Reduction

	Earned Credit	Credit Available
1025. Credit for Fire Prevention and Code Enforcement (CPCE)	0.60	2.2
1033. Credit for Public Fire Safety Education (CFSE)	0.74	2.2
1044. Credit for Fire Investigation Programs (CIP)	1.03	1.1
Item 1050. Credit for Community Risk Reduction	2.37	5.50

Item 1025 – Credit for Fire Prevention Code Adoption and Enforcement (2.2 points)	Earned Credit	Credit Available
Fire Prevention Code Regulations (PCR) Evaluation of fire prevention code regulations in effect.	10.00	10
Fire Prevention Staffing (PS) Evaluation of staffing for fire prevention activities.	0.11	8
Fire Prevention Certification and Training (PCT) Evaluation of the certification and training of fire prevention code enforcement personnel.	0.00	6
Fire Prevention Programs (PCP) Evaluation of fire prevention programs.	0.80	16
Review of Fire Prevention Code and Enforcement (CPCE) subtotal:	10.91	40

Item 1033 – Credit for Public Fire Safety Education (2.2 points)	Earned Credit	Credit Available
Public Fire Safety Educators Qualifications and Training (FSQT) Evaluation of public fire safety education personnel training and qualification as specified by the authority having jurisdiction.	0.00	10
Public Fire Safety Education Programs (FSP) Evaluation of programs for public fire safety education.	13.53	30
Review of Public Safety Education Programs (CFSE) subtotal:	13.53	40

Item 1044 – Credit for Fire Investigation Programs (1.1 points)	Earned Credit	Credit Available
Fire Investigation Organization and Staffing (IOS) Evaluation of organization and staffing for fire investigations.	8.00	8
Fire Investigator Certification and Training (IQT) Evaluation of fire investigator certification and training.	4.80	6
Use of National Fire Incident Reporting System (IRS) Evaluation of the use of the National Fire Incident Reporting System (NFIRS) for the 3 years before the evaluation.	6.00	6
Review of Fire Investigation Programs (CIP) subtotal:	18.80	20

Summary of PPC Review

for

Harmony FPSA

FSRS Item	Earned Credit	Credit Available
Emergency Communications		
414. Credit for Emergency Reporting	1.95	3
422. Credit for Telecommunicators	2.42	4
432. Credit for Dispatch Circuits	1.95	3
440. Credit for Emergency Communications	6.32	10
Fire Department		
513. Credit for Engine Companies	3.45	6
523. Credit for Reserve Pumpers	0.00	0.5
532. Credit for Pumper Capacity	2.25	3
549. Credit for Ladder Service	2.69	4
553. Credit for Reserve Ladder and Service Trucks	0.00	0.5
561. Credit for Deployment Analysis	7.87	10
571. Credit for Company Personnel	3.67	15
581. Credit for Training	1.32	9
730. Credit for Operational Considerations	2.00	2
590. Credit for Fire Department	23.25	50
Water Supply		
616. Credit for Supply System	8.46	30
621. Credit for Hydrants	2.28	3
631. Credit for Inspection and Flow Testing	3.20	7
640. Credit for Water Supply	13.94	40
Divergence	-2.33	--
1050. Community Risk Reduction	2.37	5.50
Total Credit	43.55	105.5

Final Community Classification = 06/6Y

INSURANCE SERVICES OFFICE, INC.
HYDRANT FLOW DATA SUMMARY

City Harmony Fpsa
County Iowa(Winneshiek),Minnesota(Fillmore), State IOWA (14) Witnessed by: Insurance Services Office Date: Jun 20, 2017

TEST NO.	TYPE DIST.*	TEST LOCATION	SERVICE	FLOW - GPM $Q=(29.83(C(d^2)p^{0.5}))$				PRESSURE PSI		FLOW -AT 20 PSI		REMARKS***	MODEL TYPE
				INDIVIDUAL HYDRANTS			TOTAL	STATIC	RESID.	NEEDED **	AVAIL.		
1		N Main Ave & 5th St	Harmony Water Department, 1	2160	0	0	2160	50	33	3000	2900	(C)-(830 gpm)	
2.0		N Main Ave & 5th St	Harmony Water Department, 1	2160	0	0	2160	50	33	3500	2900	(C)-(830 gpm)	
3.0		Main Ave & Central	Harmony Water Department, 1	1860	0	0	1860	45	37	3000	3400	(C)-(830 gpm)	
4.0		N Main Ave & 8th St	Harmony Water Department, 1	1010	0	0	1010	61	52	3500	2300	(C)-(830 gpm)	
5.0		1st Ave NE & 2nd St	Harmony Water Department, 1	750	0	0	750	49	41	3500	1500	(C)-(830 gpm)	
6.0		Main Ave & Central	Harmony Water Department, 1	1860	0	0	1860	45	37	3000	3400	(C)-(830 gpm)	
7.0		N Main Ave & 8th St	Harmony Water Department, 1	1010	0	0	1010	61	52	3000	2300	(C)-(830 gpm)	
8		1st Ave NE & 2nd St	Harmony Water Department, 1	750	0	0	750	49	41	750	1500		

THE ABOVE LISTED NEEDED FIRE FLOWS ARE FOR PROPERTY INSURANCE PREMIUM CALCULATIONS ONLY AND ARE NOT INTENDED TO PREDICT THE MAXIMUM AMOUNT OF WATER REQUIRED FOR A LARGE SCALE FIRE CONDITION.

THE AVAILABLE FLOWS ONLY INDICATE THE CONDITIONS THAT EXISTED AT THE TIME AND AT THE LOCATION WHERE TESTS WERE WITNESSED.

*Comm = Commercial; Res = Residential.

**Needed is the rate of flow for a specific duration for a full credit condition. Needed Fire Flows greater than 3,500 gpm are not considered in determining the classification of the city when using the Fire Suppression Rating Schedule.

*** (A)-Limited by available hydrants to gpm shown. Available facilities limit flow to gpm shown plus consumption for the needed duration of (B)-2 hours, (C)-3 hours or (D)-4 hours.

Resolution No. 17-08

**RESOLUTION ADOPTING ASSESSMENT FOR 2017 STREET AND UTILITY
RECONSTRUCTION PROJECT**

WHEREAS, pursuant to proper notice duly given as required by law, the council has met and heard and passed upon all objections to the proposed assessment for the reconstruction of 2nd Ave SW from 3rd St SW to 5th St SW, 5th St SW from 1st Ave SW west to dead end, 4th St SW from 1st Ave SW to 2nd Ave SW, Center St W from 1st Ave SW to 3rd Ave SW, and 2nd Ave St NE from 2nd Ave NE east to dead end by the installation of water and sanitary sewer utilities and services, curb & gutter, sidewalk, storm sewer and the reconstruction of streets.

NOW THEREFORE BE IT RESOLVED, by the Council of the City of Harmony, Fillmore County, Minnesota, as follows:

1. Such proposed assessment, a copy of which is attached hereto and made a part hereof, is hereby accepted and shall constitute the special assessment against lands named therein, and each tract of land therein included is hereby found to be benefited by the proposed improvement in the amount of the assessment levied against it.
2. Such assessments shall be payable in equal installments extending over a period of ten (10) years, the first of the installments to be payable on or after the first Monday in January, 2018, and shall bear interest at the rate of five and zero-tenths percent (5.0%) per annum from the date of the adoption of this assessment resolution. To the first installment shall be added interest on the entire assessment from the date of this resolution to December 31, 2018. To each subsequent installment when due shall be added interest for one year on all unpaid installments
3. The owner of any property so assessed may, any time prior to the certification of the assessment to the County Auditor, pay the whole of the assessment on such property, with interest accrued to the date of payment, to the City Clerk, except that no interest shall be charged if the entire assessment is paid within thirty (30) days from the adoption of this resolution. The owner may at any time thereafter, pay to the County Auditor the entire amount of the assessment remaining unpaid, with interest accrued to December 31 of the year in which such payment is made. Such payment must be made before November 15 or interest will be charged through December 31 of the succeeding year.
4. The City Clerk shall forthwith transmit a certified duplicate of this assessment to the County Auditor to be extended on the property tax lists of the county. Such assessments shall be collected and paid over in the same manner as other municipal taxes.

The foregoing resolution was introduced and moved for adoption by Council Member _____ and seconded by Council Member _____.

Voting for the Resolution:

Voting Against the Resolution:

Abstained from Voting:
Absent:

Motion carried and resolution adopted this 14th day of November 2017.

Steve Donney, Mayor

ATTEST:

Jerome Illg, Administrator

ASSESSMENT HEARING
2017 Street and Utility Improvements
Harmony, MN
November 14, 2017

I. Improvement Areas:

Area 1: Portions of 4th Street SW, 2nd Avenue SW and 5th Street SW. (See Figure).
Area 2: Center Street West from 1st Avenue SW to 3rd Avenue SW. (See Figure).
Area 3: 2nd Street NE from 2nd Avenue NE to Dead End (See Figure).

II. Utility Improvements:

Area 1: Replacement of the trunk water main, portions of the sanitary sewer, and utility services affected by the main installations.
Area 2: Replacement of the trunk water main, portions of the sanitary sewer, and utility services affected by the main installations.
Area 3: Replacement of the trunk water main, sanitary sewer, and utility services affected by the main installations.

III. Street Improvements:

Area 1: All roadway corridors were reconstructed with geotextile fabric, 15-inches of class 5 aggregate base, and 3.5-inches of bituminous pavement. Replacement of existing concrete curb and gutter, carriage walk connections, pedestrian curb ramps, and driveway approaches were completed with the improvement. The constructed roadway width is 28-feet from face of curb to face of curb.
Area 2: Replacement of the trunk water main, portions of the sanitary sewer, and utility services affected by the main installations. The roadway corridor was reconstructed with geotextile fabric, 15-inches of class 5 aggregate base, and 3.5-inches of bituminous pavement. Replacement of existing concrete curb and gutter along the south side of the roadway, and necessary curb and gutter on the north side of the roadway, carriage walk connections, sidewalk affected by the utility installations, pedestrian curb ramps, and driveway approaches were completed with the improvement. Center Street was reconstructed to its previous width of approximately 29.2-feet from face of curb to face of curb.
Area 3: The roadway corridor was reconstructed with geotextile fabric, 15-inches of class 5 aggregate base, and 3.5-inches of bituminous pavement. Replacement of existing concrete curb and gutter, carriage walk connections, pedestrian curb ramps, and driveway approaches were completed with the improvement. The proposed roadway width is 28-feet from face of curb to face of curb.

IV. Final Project Costs:

TYPE OF IMPROVEMENT	PROJECT COSTS	ASSESSED PORTION	REMAINING PROJECT COSTS
SANITARY SEWER	\$73,501.55	\$0.00	\$73,501.55
WATER MAIN	\$186,768.82	\$0.00	\$186,768.82
SERVICES	\$96,776.27	\$96,776.27	\$0.00
ROADWAY	\$537,037.57	\$205,880.75	\$331,156.82
TOTALS	\$894,084.20	\$302,657.02	\$591,427.19

V. Proposed Assessments:

ASSESSMENT TYPE	CALCULATED ASSESSABLE FRONT FOOTAGE	UNITY PRICE OF ASSESSMENT	ASSESSMENT TOTALS
STREET IMPROVEMENTS	2,763.50 LF	\$74.50/ LF	\$205,880.75
WATER SERVICE	35 SERVICES	\$1,753.56/ SERVICE	\$61,374.60
SANITARY SERVICE	20 SERVICES	\$1,509.62/ SERVICE	\$30,192.40

The proposed total assessment to benefitting property owners is estimated to be \$297,447.75, or 33.27% of the total project cost. The proposed assessments will be incorporated into the property taxes of all assessed parcels unless prepaid by the property owner prior to filing of the assessments with Fillmore County.

VI. Basis of Proposed Assessments:

- Assessment of 40% of the street reconstruction project costs to property owner (32-Foot Maximum Street Width).
- Assessment of 100% of the water service reconstruction to property owner.
- Assessment of 100% of the sanitary sewer service reconstruction to property owner.
- Maximum residential assessment of 150 lineal feet, minimum residential assessment of 60 lineal feet)
- Assess only 20% of frontage along second side of a corner and dual frontage lots.
- City pays 100% of trunk water main cost.
- City pays 100% of trunk sewer main cost.
- City pays 100% of storm sewer cost.
- City pays 100% of sidewalk cost.
- Additional assessment criteria contained within the City Assessment Policy.

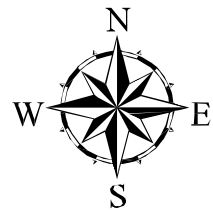

- IMPROVEMENT AREA 1: —
- IMPROVEMENT AREA 2: —
- IMPROVEMENT AREA 3: —

CORPORATE LIMITS

CORPORATE LIMITS

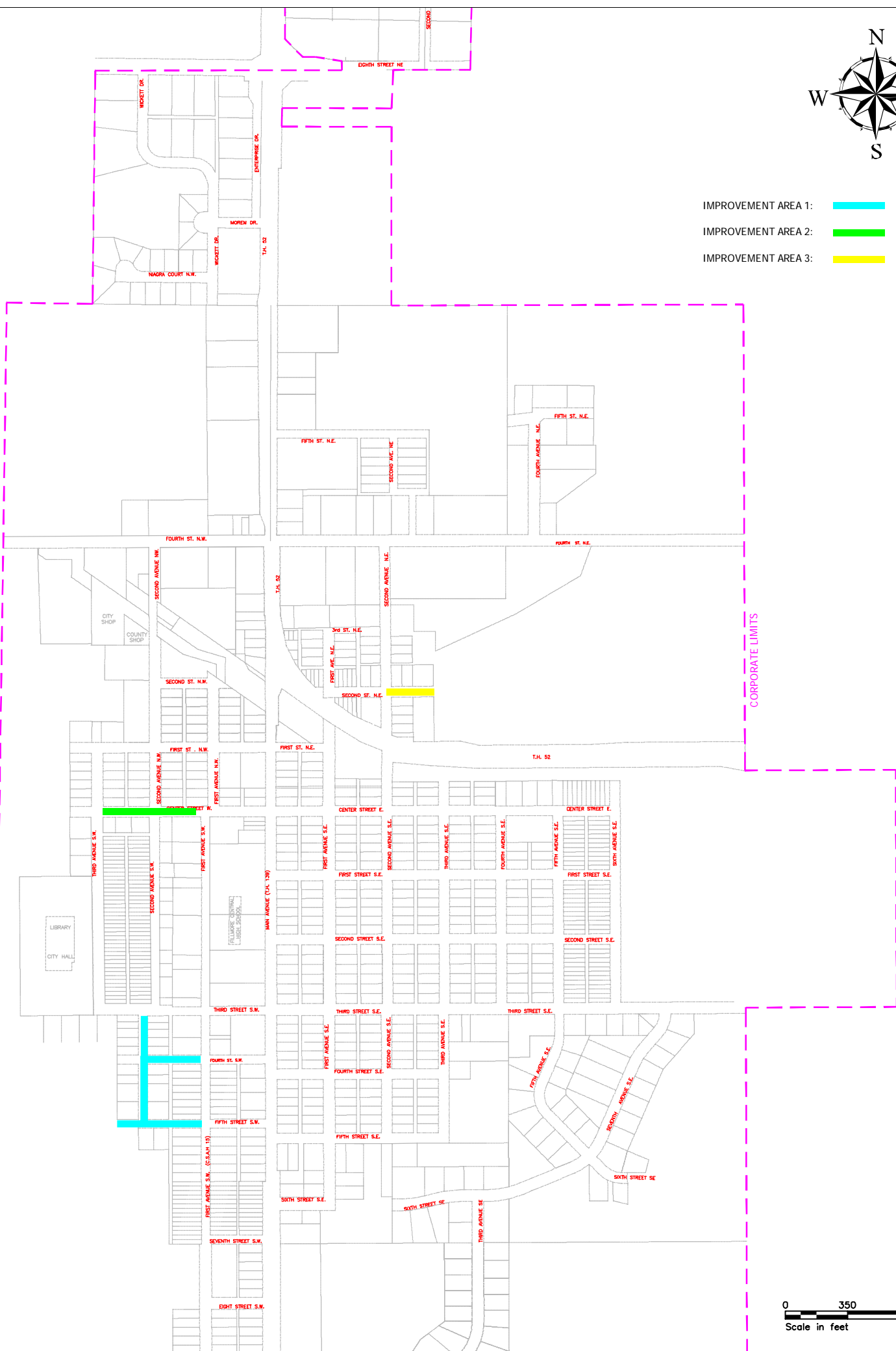
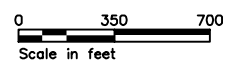

City of Harmony
2017 Street Improvement Project
Proposed Assessment Roll

First Name	Last Name	Surname	House No.	Street Name	Mailing Address	City	State	Zip	PID	Assessable Frontage				Assessable Water Service	Assessable Sewer Service	Street Assessment Amount	Water Assessment Amount	Sewer Assessment Amount	Total Assessment Amount
										Actual Frontage	Min 60/ Max 150	Front 100% Side 20%	Frontage Assessed						
Oscar	Armstrong	Oscar	345	1st Ave SW	345 1st Ave SW	Harmony	MN	55939	15.0202.000	90	90	20%	18			1,341.00	0.00	0.00	1,341.00
Laurie	Lenard	Laurie	425	1st Ave SW	425 1st Ave SW	Harmony	MN	55929	15.0183.000	162	150	20%	30	1		2,235.00	1,753.56	0.00	3,988.56
Andy	Bunge	Andy	455	1st Ave SW	1105 St Paul St	Preston	MN	55965	15.0185.000	162	150	20%	30	1	1	2,235.00	1,753.56	1,509.62	5,498.18
Matthew	Cleven	Matthew	515	1st Ave SW	515 1st Ave SW	Harmony	MN	55939	15.0205.000	98	98	20%	20	1		1,460.20	1,753.56	0.00	3,213.76
Kathryn	Bigalk	Kathryn	105	5th St SW	105 5th St SW	Harmony	MN	55939	15.0205.030	64	64	100%	64	1	1	4,768.00	1,753.56	1,509.62	8,031.18
Emily	Morgan	Emily	135	5th St SW	135 5th St SW	Harmony	MN	55939	15.0470.000	85	85	100%	85	1		6,332.50	1,753.56	0.00	8,086.06
Ryan	Lee	Ryan	145	5th St SW	145 5th St SW	Harmony	MN	55939	15.0471.000	85	85	100%	85	1		6,332.50	1,753.56	0.00	8,086.06
Kyle	Morem	Kyle	215	5th St SW	215 5th St SW	Harmony	MN	55939	15.0008.020	105	105	100%	105	1	1	7,822.50	1,753.56	1,509.62	11,085.68
Erin	McKay	Erin	435	2nd Ave SW	435 2nd Ave SW	Harmony	MN	55939	15.0472.000	120	120	20%	124	1		9,238.00	1,753.56	0.00	10,991.56
Kerry	Kingsley	Kerry	425	2nd Ave SW	P.O. Box 214	Harmony	MN	55939	15.0473.000	100	100	100%	100	1		7,450.00	1,753.56	0.00	9,203.56
Kerry	Kingsley	Kerry	425	2nd Ave SW	P.O. Box 214	Harmony	MN	55939	15.0214.010	12	12	100%	12			894.00	0.00	0.00	894.00
Jacob	Nash	Jake	415	2nd Ave SW	415 2nd Ave SW	Harmony	MN	55939	15.0214.000	98	98	100%	98	1		7,301.00	1,753.56	0.00	9,054.56
Robert	Trouten	Bob	335	2nd Ave SW	335 2nd Ave SW	Harmony	MN	55939	15.0213.000	110	110	100%	110	1	1	8,195.00	1,753.56	1,509.62	11,458.18
Linda	Polesky	Linda	315	2nd Ave SW	315 2nd Ave SW	Harmony	MN	55939	15.0212.000	120	120	20%	24			1,788.00	0.00	0.00	1,788.00
Eric	Corson	Eric	310	2nd Ave SW	512 Pleasant St NE	Preston	MN	55965	15.0211.010	125	125	20%	25			1,862.50	0.00	0.00	1,862.50
Kortni	Pierce	Kortni	140	4th St SW	140 4th St SW	Harmony	MN	55939	15.0210.000	100	100	20%	140	1	1	10,430.00	1,753.56	1,509.62	13,693.18
Daniel	Miller	Dan	120	4th St SW	P.O. Box 611	Harmony	MN	55939	15.0202.010	72	72	100%	72	1	1	5,364.00	1,753.56	1,509.62	8,627.18
Joe	Afseth	Joe	135	4th St SW	135 4th St SW	Harmony	MN	55939	15.0209.000	120	120	100%	142	1		10,579.00	1,753.56	0.00	12,332.56
Teresa	Hanson	Teresa	430	2nd Ave SW	430 2nd Ave SW	Harmony	MN	55939	15.0468.000	100	100	100%	100	1		7,450.00	1,753.56	0.00	9,203.56
Cory	Tammel	Cory	440	2nd Ave SW	440 2nd Ave SW	Harmony	MN	55939	15.0469.000	100	100	100%	124	1		9,238.00	1,753.56	0.00	10,991.56
Barbara	Keist	Barbara	115	Center St W	807 7th Ave NW	Austin	MN	55912	15.0074.020	95	95	100%	95	1	1	7,077.50	1,753.56	1,509.62	10,340.68
Marlene	Fishbaugher	Marlene	125	Center St W	125 Center St W	Harmony	MN	55939	15.0074.010	67	67	100%	67	1	1	4,991.50	1,753.56	1,509.62	8,254.68
Steve	Hines	Steve	135	Center St W	P.O. Box 477	Harmony	MN	55939	15.0075.000	70	70	100%	70	1	1	5,215.00	1,753.56	1,509.62	8,478.18
Judy	Affeldt	Judy	215	Center St W	215 Center St W	Harmony	MN	55939	15.0078.000	90	90	100%	90	1	1	6,705.00	1,753.56	1,509.62	9,968.18
Gregory	Mock	Greg	235	Center St W	235 Center St W	Harmony	MN	55939	15.0077.000	85	85	100%	85	1	1	6,332.50	1,753.56	1,509.62	9,595.68
Jon	Bessingpas	Jon	245	Center St W	245 Center St W	Harmony	MN	55939	15.0080.000	85	85	100%	85	1	1	6,332.50	1,753.56	1,509.62	9,595.68
Rodney	Gregerson	Rodney	240	Center St W	P.O. Box 597	Harmony	MN	55939	15.0169.000	120	120	100%	120	1	1	8,940.00	1,753.56	1,509.62	12,203.18
Renee	Ristau	Renee	220	Center St W	220 Center St W	Harmony	MN	55939	15.0168.010	50	60	100%	60	1	1	4,470.00	1,753.56	1,509.62	7,733.18
Ruth	Snyder	Ruth	210	Center St W	210 Center St W	Harmony	MN	55939	15.0168.000	70	70	100%	70			5,215.00	0.00	0.00	5,215.00
Larry	Torgerson	Larry	140	Center St W	P.O. Box 323	Harmony	MN	55939	15.0121.010	120	120	100%	120		1	8,940.00	0.00	1,509.62	10,449.62
Ralph	Schansberg	Ralph	120	Center St W	P.O. Box 74	Harmony	MN	55939	15.0115.000	50	60	100%	60	1	1	4,470.00	1,753.56	1,509.62	7,733.18
Ramona	Cloutier	Ramona	15	1st Ave NW	P.O. Box 303	Harmony	MN	55939	15.0114.000	70	70	20%	14			1,043.00	0.00	0.00	1,043.00
Janeen	Olson	Janeen	160	2nd Ave NE	160 2nd Ave NE	Harmony	MN	55939	15.0361.000	120	120	20%	24			1,788.00	0.00	0.00	1,788.00
Henry	Becker	Henry		2nd St NE	P.O. Box 674	Rushford	MN	55971	15.0036.000	117	117	100%	117	3	2	8,716.50	5,260.68	3,019.24	16,996.42
Harmony	Transit	Mark		2nd St NE	P.O. Box 35	Harmony	MN	55939	15.0034.010		60	100%	-	1		0.00	1,753.56	0.00	1,753.56
Harmony	Golf Club	Steve		2nd St NE	P.O. Box 475	Harmony	MN	55939	15.0024.020		60	100%	-	1		0.00	1,753.56	0.00	1,753.56
Jimmy	Bidsler	Jimmy	240	2nd St NE	8801 130th Ave SE	Chatfield	MN	55923	15.0022.010	100	100	100%	100	1	1	7,450.00	1,753.56	1,509.62	10,713.18
Robert K	Johnson	Bob	230	2nd St NE	230 2nd St NE	Harmony	MN	55939	15.0022.000	16.5	16.5	100%	16.5	1	1	1,229.25	1,753.56	1,509.62	4,492.43
Robert K	Johnson	Bob	230	2nd St NE	230 2nd St NE	Harmony	MN	55939	15.0357.010	48	48	100%	48			3,576.00	0.00	0.00	3,576.00
Jenny	Rasmussen	Jenny	210	2nd Ave NE	210 2nd Ave NE	Harmony	MN	55939	15.0357.000	72	72	20%	14	1		1,072.80	1,753.56	0.00	2,826.36
James	Hellem	James	340	1st St NE	P.O. Box 84	Harmony	MN	55939	15.0034.000				-	1		0.00	1,753.56	0.00	1,753.56
James	Hellem	James	360	1st St NE	P.O. Box 84	Harmony	MN	55939	15.0004.000				-	1		0.00	1,753.56	0.00	1,753.56
Total										2,763.5				35	20	205,880.75	61,374.60	30,192.40	297,447.75

Assessment Rate	74.50	1,753.56	1,509.62	
Total Project Costs				894,084.20
Difference				596,636.45
% Assessed				33.27%